

Floor Map

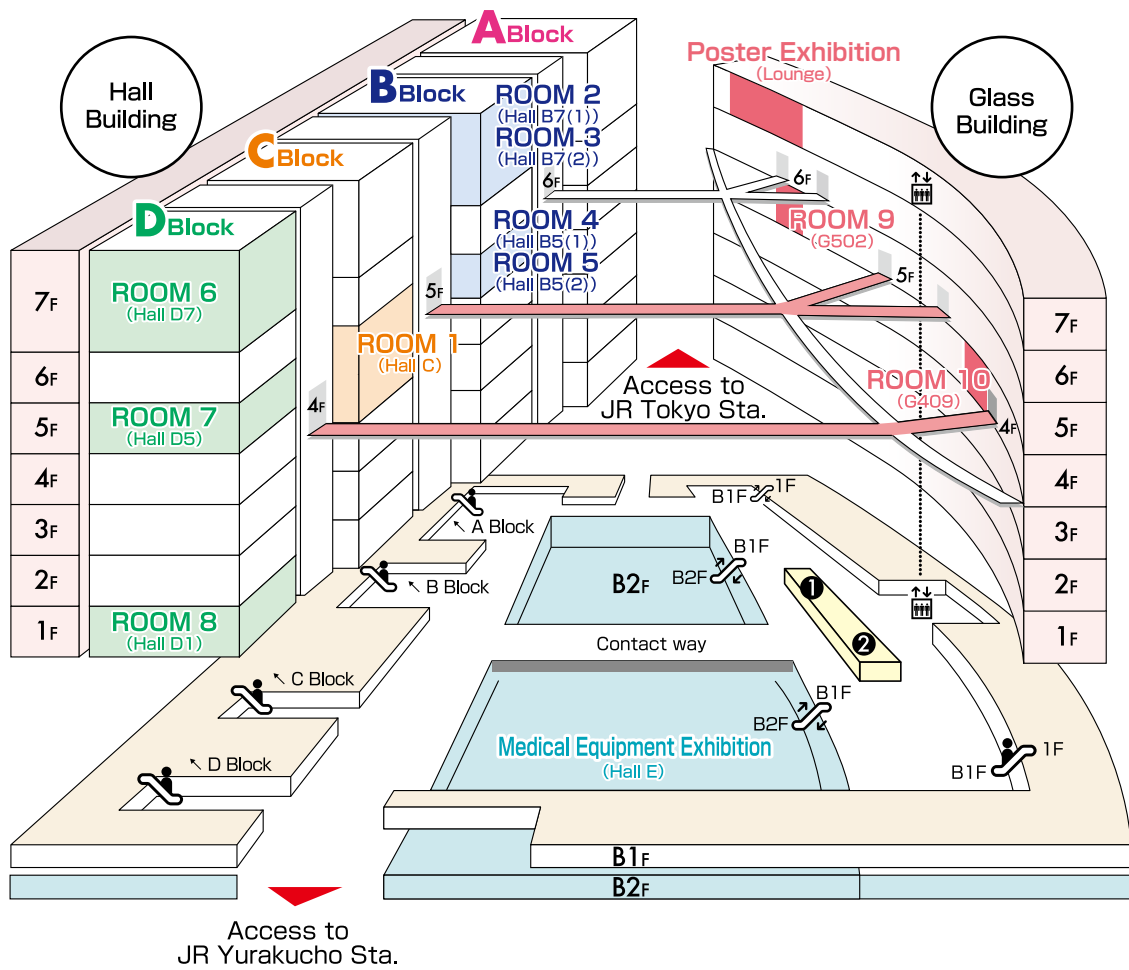

Hall Building
← →
 Passageway connects Hall Building with Glass Building on B1, 4th, 5th & 6th floors.
 Glass Building

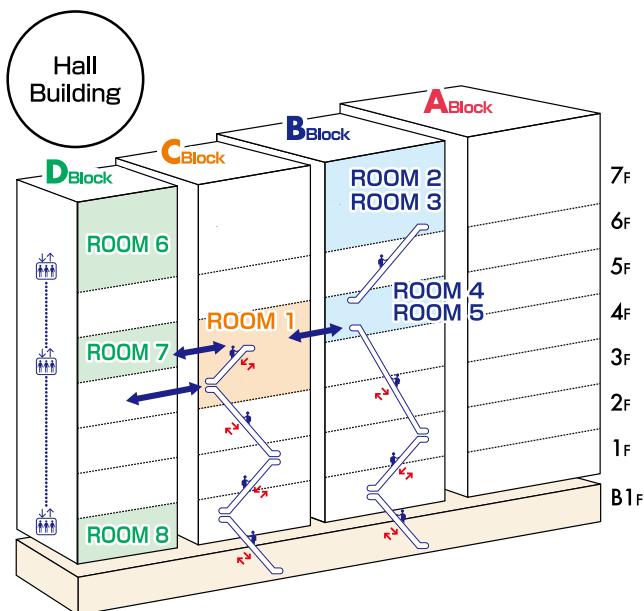

| | | |
|------------------------------|---|------------|
| ROOM 1 | C Block 4, 5F | Hall C |
| ROOM 2 | B Block 7F | Hall B7(1) |
| ROOM 3 | B Block 7F | Hall B7(2) |
| ROOM 4 | B Block 5F | Hall B5(1) |
| ROOM 5 | B Block 5F | Hall B5(2) |
| ROOM 6 | D Block 7F | Hall D7 |
| ROOM 7 | D Block 5F | Hall D5 |
| ROOM 8 | D Block 1F | Hall D1 |
| ROOM 9 | Glass Building 5F | G502 |
| ROOM 10 | Glass Building 4F | G409 |
| Poster Exhibition | Glass Building 7F | Lounge |
| Medical Equipment Exhibition | B2F | Hall E |
| ① B1F | PC Center, Registration Desk | |
| ② B1F | Cloak Room, Luncheon Seminar Ticket Desk, Conference Bag Desk | |

Floor Map

B2F

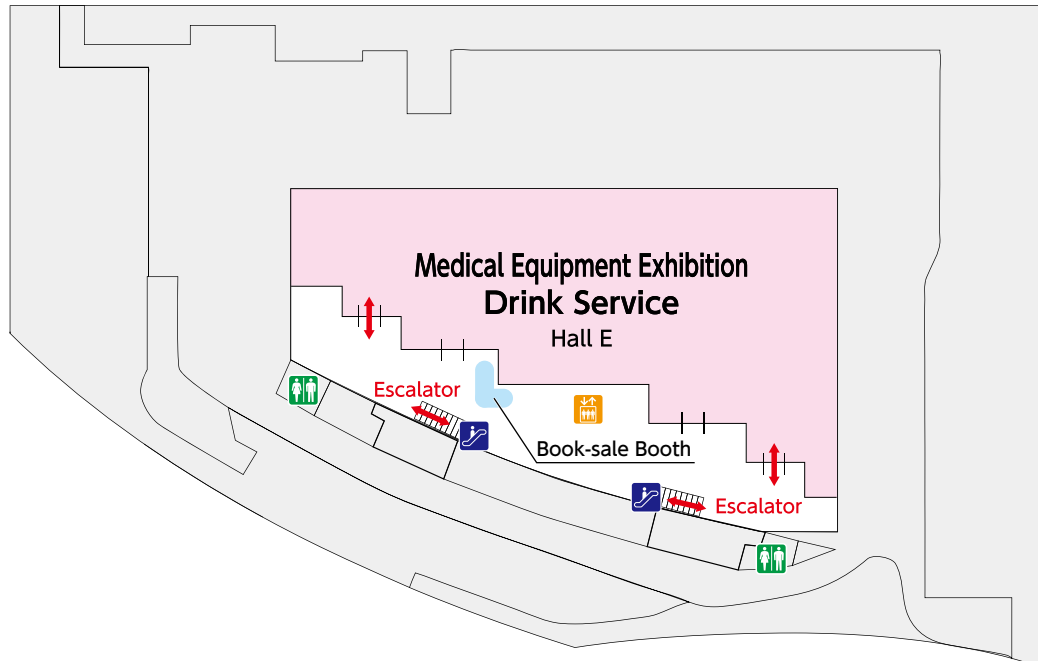

Floor Map

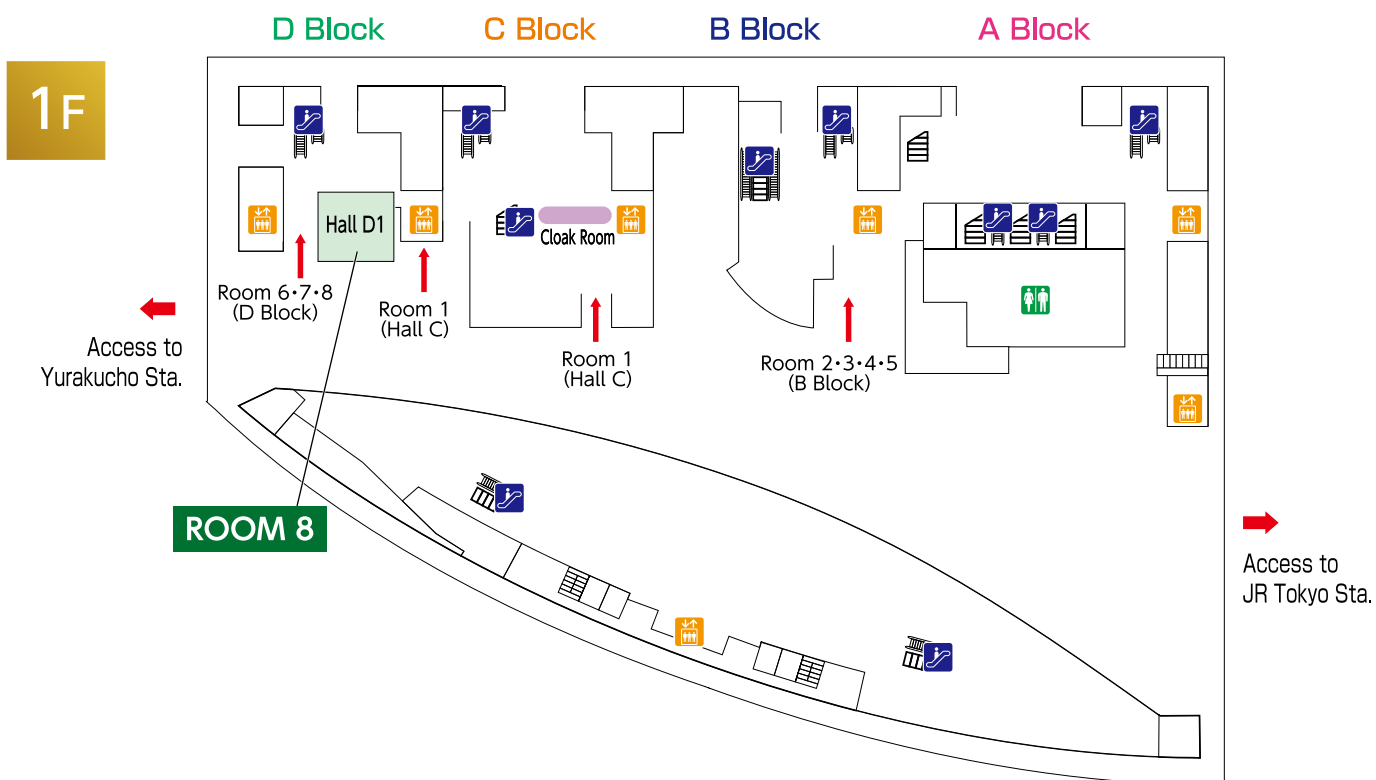
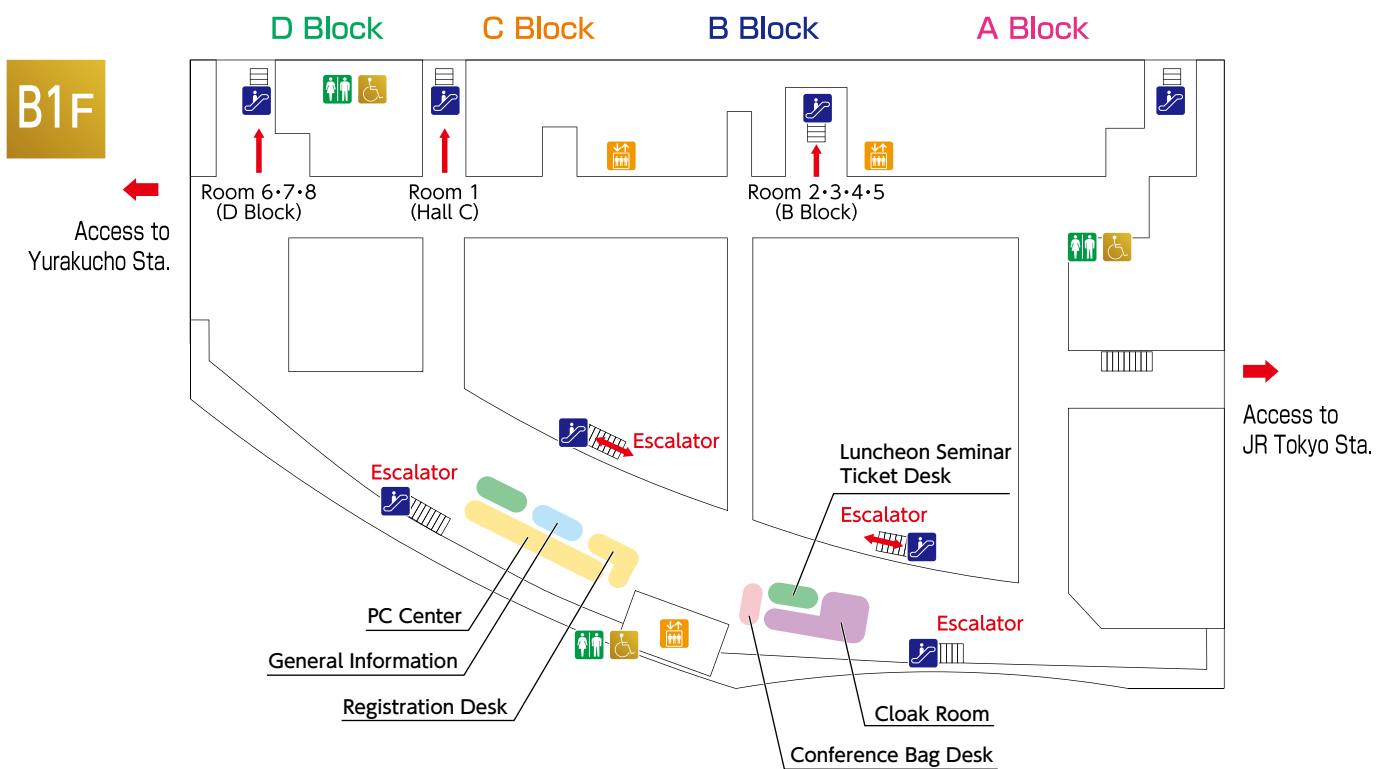

Floor Map

4F

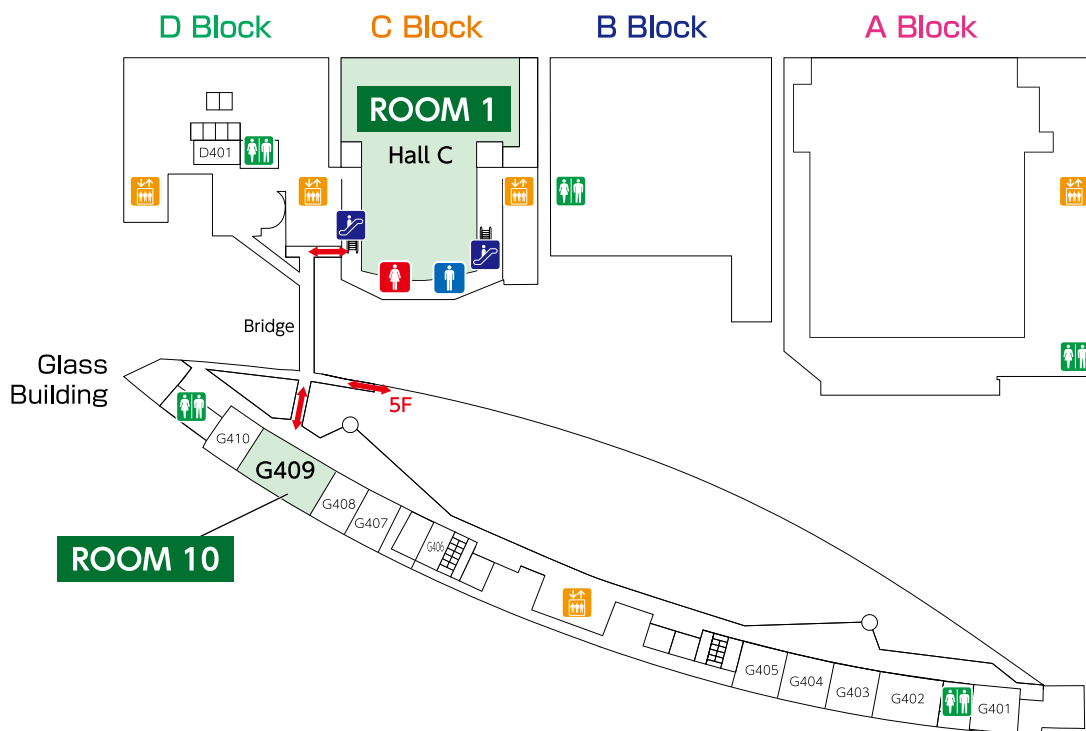

5F

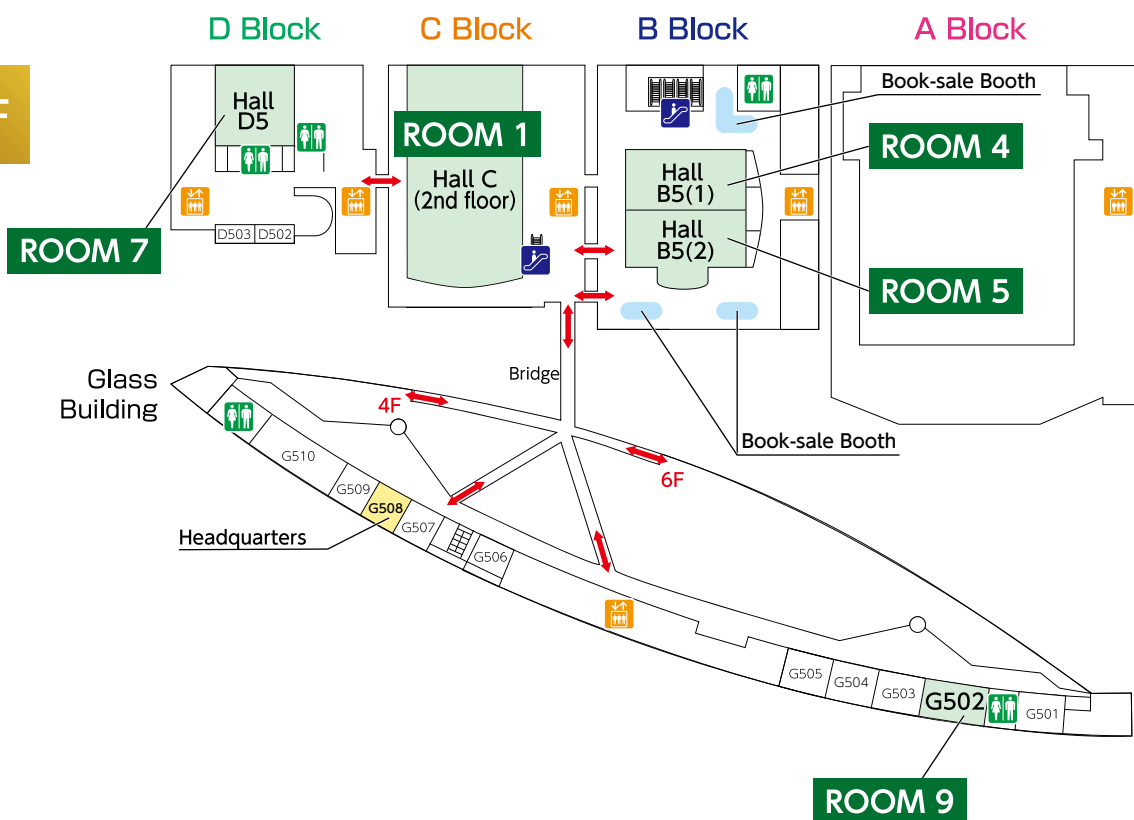

Floor Map

7F

