

# The 66th Annual Meeting of the Japanese Society of Anesthesiologists



Chairman: Professor Kimitoshi Nishiwaki  
(Department of Anesthesiology, Nagoya University Graduate School of Medicine)

I am honored to have been appointed as the Chairman of the 66th Annual Meeting of the Japanese Society of Anesthesiologists (JSA). I would like to take this opportunity to express my heartfelt gratitude in greeting. The 66th Annual Meeting will be held in Kobe for the three-day period from May 30 to June 1, 2019. Although I would have preferred to invite you all to Nagoya, as we did for the 51st Annual Meeting, our numbers of the participants have increased so dramatically since then that we have decided to return to Kobe, both from the perspective of securing a suitable conference venue and because of a range of advantages in financial terms; my experience as the Treasurer of the JSA has contributed to the decision to choose Kobe as the location. I am grateful for your understanding on this issue.

The all members of the Executive Committee including me are working hard to put together an Annual Meeting that will live up to our member's expectations. We will be inviting members to give lectures, chair discussions, and review submissions, and your help and support on every front are greatly appreciated. It is our member's presentations that constitute the heart and soul of our academic meeting. Because of the various different aspects that must now be taken into consideration when conducting clinical research, the application procedures have become more complex, but I still look forward to hearing many excellent presentations from our membership and all over the world.

We have chosen "Professionalism" as the theme of this Annual Meeting. The work of anesthesiologists is a nonstop series of pressing decisions. Every day, we proceed by making judgements at every level: in clinical practice, the pre-operative evaluation of individual patients and their perioperative management, including anesthesia and postoperative pain relief; diagnostic and therapeutic choices in intensive care and pain clinics; clinical and basic research to suggest ways of resolving the issues that arise in these situations; these and other roles of anesthesiologists in hospitals; the role of anesthesiologists in patient safety, both inside and outside hospitals; and the role and policy of the JSA as the organization responsible for providing anesthesia within the Japanese healthcare system. When making these decisions, views from different perspectives may come into conflict, and it is our professionalism as anesthesiologists that provides the backbone supporting the entire process of making overall decisions. I believe that comparing our professional attitudes and identifying the criteria for action on which our judgments should be based will enable us to unwaveringly make the correct decisions. At this Annual Meeting, we will consider a wide range of issues in anesthesiology from the viewpoint of professionalism, which I hope will provide us with the opportunity to think about what we should be doing and the direction in which we should be heading.

In this Annual Meeting, we are continuing the simultaneous interpretation service for overseas presenters. We are working to minimize the language barrier, and I would like to encourage participants to actively attend sessions given by presenters from other countries in order to learn the latest knowledge and take the opportunity to extend international networks of communication. The pitch contest, for which selections started at the 64th Annual Meeting and the first results were announced at the 65th, will also continue. I am very much looking forward to receiving your submissions and to hearing your presentations.

## General Information

### The 66th Annual Meeting of the Japanese Society of Anesthesiologists

**Dates** May 30th (Thu.) - June 1st (Sat.), 2019

**Venue** Kobe Portopia Hotel  
6-10-1 Minatojima Nakamachi, Chuo-ku, Kobe 650-0046, Japan  
TEL: +81-78-302-1111  
URL: <https://www.portopia.co.jp/en/>

Kobe International Exhibition Hall  
6-11-1 Minatojima-nakamachi, Chuo-ku, Kobe 650-0046, Japan  
TEL: +81-78-302-1020  
URL: <https://kobe-cc.jp/en/facilities/exhibition-hall/>

Kobe International Conference Center  
6-9-1 Minatojima-nakamachi, Chuo-ku, Kobe 650-0046, Japan  
TEL: +81-78-302-5200  
URL: <https://kobe-cc.jp/en/facilities/conference-center/>

**Chairman** Kimitoshi Nishiwaki  
Department of Anesthesiology, Nagoya University Graduate School of Medicine

**Theme** Professionalism

**Contact** Congress Secretariat  
c/o Congress Corporation  
3-6-13 Awajimachi, Chuo-ku, Osaka 541-0047, Japan  
TEL: +81-6-6229-2555  
E-mail : [jsa@congre.co.jp](mailto:jsa@congre.co.jp)  
URL: <http://www.congre.co.jp/jsa66/en/index.html>

### Registration

\*Please register at the Registration Desk onsite. Advance registration is NOT accepted.

\*Registration fee is JPY 17,000.

### Location and Hours for Conference Registration

Day	Hours	Location
May 29th (Wed.)	0:00pm~7:00pm	Exhibition Hall No.1 Building 1F, Kobe International Exhibition Hall
May 30th (Thu.)	7:30am~7:00pm	
May 31st (Fri.)	7:30am~6:30pm	
June 1st (Sat.)	7:30am~4:00pm	Waraku, Main Building B1F, Kobe Portopia Hotel

### Wireless LAN

We provide Wi-Fi access.

SSID	Password
66thJSA	66masuika

\*Please note that Wi-Fi connection may be slow depending on the number of users.

### Cloakroom

The cloakroom is available during the hours below. Be sure to collect items deposited in the cloakroom within these hours. Please note that the number of items you can keep in the cloakroom is limited.

Day	Hours	Location
May 29th (Wed.)	10:30am~8:30pm	• South Wing 1F, Kobe Portopia Hotel
May 30th (Thu.)	7:30am~8:00pm	• Exhibition Hall No.1 Building 1F, Kobe International Exhibition Hall
May 31st (Fri.)	7:30am~6:30pm	• Ikuta, Main Building B1F, Kobe Portopia Hotel • South Wing 1F, Kobe Portopia Hotel
June 1st (Sat.)	7:30am~4:30pm	• Ikuta, Main Building B1F, Kobe Portopia Hotel • South Wing 1F, Kobe Portopia Hotel

### Refreshment Corner

Refreshment services are available at the following locations/hours during the meeting

	Date & Hours	Location
Water server	May 30th (Thu.)~June 1st (Sat.) Throughout the meeting hours	South Wing, 1F & B1F Kobe Portopia Hotel
Beverage	May 30th (Thu.), 31st (Fri.) 9:00am~5:00pm	No.3 Building, 1F Kobe International Exhibition Hall
Confectionery	May 30th (Thu.), 31st (Fri.) 10:30am~2:00pm	No.3 Building, 1F Kobe International Exhibition Hall

### Social Program (with additional charge)

Program	Fee	Date & Time	Venue
Congress Banquet	JPY1,000	May 31st (Fri.) 6:00pm~8:00pm	Ohwada, South Wing 1F, Kobe Portopia Hotel

\*Please register and pay upon conference registration.

\*Invited speakers are free of charge.

## ■ Presenter Instruction

Conflict of interest: COI

### Disclosure of Conflict of Interest at the Annual Meeting of the Japanese Society of Anesthesiologists

In accordance with the regulations on application for approval of the Conflict of Interest Policy published in June 2010, the Japanese Society of Anesthesiologists (JSA) has been asking speakers at the annual meetings of the JSA, beginning in 2010, to disclose any Conflicts of Interest.

When you submit your abstract, please declare whether there are conflicts of interest amongst any businesses affiliated with the research and representative speakers including co-authors and co-researchers within the past three years.

Please disclose any COI when you make your presentation at the meeting. Oral presenters must include this slide in the second page of the presentation slides. Poster presenters must indicate this status either at the beginning or the end of the poster. Please find the COI at website.

### **[Instructions for Poster Presenters]**

Please note that if you fail to attend the meeting in Kobe without prior notice, you will lose the right to submit abstracts at any meetings of the Japanese Society of Anesthesiologists for one year from the date of absence.

### **Presentation Style**

Authors are required to be present during their designated poster session.

Presentation Style	Time for Presentation	Time for Discussions	Venue
Poster Discussions	7 minutes	5 minutes	Nojigiku, Sumire, Tsutsuji (2F) Nunobiki and Kitano (B1F), Main Building, Kobe Portopia Hotel
Poster Presentations	5 minutes	3 minutes	Exhibition Hall, No.1 Building, 2F Kobe International Exhibition Hall

### **<Poster Discussions>**

- You have 7 minutes for presentation and 5 minutes for discussions to take place in front of your mounted poster.
- Each presenter has to set up his/her poster in the Poster discussions rooms.
- A specific poster board identified by an abstract number will be assigned to the authors.
- If your presentation time is in the morning, please set up your poster between 8:00am and 9:00am. Afternoon presenters should proceed by 1:00pm. Presenters are required to be in attendance during the designated time. All posters must be taken down by 5:30pm of your presentation day. Any posters left remaining will be removed.

### **<Poster Presentations>**

- You have 5 minutes for presentation and 3 minutes for discussion to take place in front of your mounted poster.
- Each presenter has to set up his/her poster in the Poster presentations area.
- A specific poster board identified by an abstract number will be assigned to the authors.
- If your presentation time is in the morning, please set up your poster between 8:00am and 9:00am. Afternoon presenters should proceed by 1:00pm. Presenters are required to be in attendance during the designated time. All posters must be taken down by 5:30pm of your presentation day. Any posters left remaining will be removed.

## Poster Panel

- The size of the board is 160 cm (high) × 90 cm (wide).
- Layout and print your poster clearly so that everyone can see your presentation even if they are standing slightly away from the panel.
- Do not mount anything in the upper left corner of the panel (15 cm × 20 cm), as there will be a poster number in this space.
- Bring your own abstract title and author information for the board.
- At the bottom of the panel posters, please disclose any conflicts of interest.
- Thumbtacks are available at each panel.

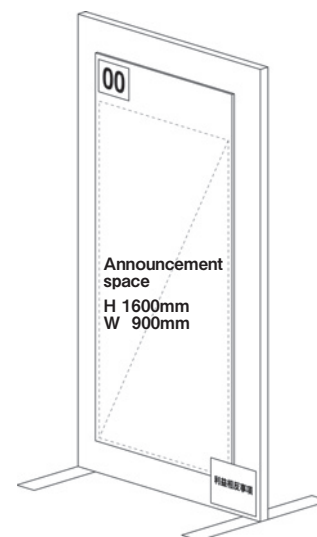

Presentation Style	Presentation Time Slot	Poster Mount	Poster Removal
Poster Discussions	9:30am~11:00am	8:00am~9:00am	After the presentation (by 5:30pm of your presentation day)
	1:30pm~ 3:00pm	8:00am~1:00pm	
Poster Presentations	10:00am~11:00am	8:00am~9:00am	
	3:30pm~ 4:30pm	8:00am~1:00pm	

## 【Instructions for Invited Speakers】

Please report to the “Preview Center” at least 1 hour before your presentation (or the day before for morning sessions) to confirm and review your presentation material.

Opening hours and locations are as follows:

Venue	May 29th (Wed.)	May 30th (Thu.)	May 31st (Fri.)	June 1st (Sat.)
South Wing, 1F Kobe Portopia Hotel	5:00pm~7:00pm	7:30am~6:30pm	7:30am~5:00pm	7:30am~3:00pm
Main Building, B1F Kobe Portopia Hotel	-	7:30am~6:30pm	7:30am~5:00pm	7:30am~3:00pm
No.2 Building, 1F Kobe International Exhibition Hall	-	7:30am~6:30pm	7:30am~5:00pm	-

## Available audiovisual material for your presentation:

- Single PowerPoint projection (PC compatible mandatory)

## How to hand in your MS-PowerPoint presentation material

- You can bring in USB memory units, CD-R

## Important Points

- After the preview, presentation data will be delivered to each lecture room over the LAN.
- The received PowerPoint presentation material will be checked by congress staff and prepared for the lecture. It will be stored on the central congress server.
- Computers will be equipped with the followings:

OS	Application
Windows10	PowerPoint 2010/2013/2016
Macintosh Mac OS X	PowerPoint 2011/2016

\*Keynote is not available.

## In the lecture room





- Each lecture room will be equipped with a computer and an LCD projector for PowerPoint presentations.
- Your PowerPoint presentation will be made available in your lecture room via a computer network.

- There will be a room attendant to help you to operate the computer if necessary.
- From the podium you will be able to control your PowerPoint presentation on your own.
- In case you prefer to connect your personal laptop in the lecture room, please make sure you have supply cable for your PC.
- A pointer/laser-pointer will be available.
- Neither overhead projector nor slide projector will be available in the lecture rooms; double projection will not be provided.
- No changes in your presentation can be made in the lecture room. If you want to make any changes after you checked your data in at the Preview Center, please go back to the Preview Center for revisions.

#### **Further details on the preparation of your MS-PowerPoint presentation**

- Store all your files in one folder. Please make sure that graphics, animations, videos and your presentation are all in the same folder.
- Avoid creating symbols as graphics or using special fonts that are external to your Microsoft PowerPoint or word processing program since these might be displayed incorrectly. Instead, always use the 'Symbol' function in the 'Insert' menu of your program to insert symbols.
- Colors: Use light-colored fonts for texts on dark backgrounds or vice versa. A strong contrast is important for good legibility.
- Legibility check: On presentation mode, your text should be large enough to be easily readable 5 feet (1.5 meters) away from your computer screen.
- All versions after Microsoft PowerPoint XP, Vista Windows7, 8 can be used. Any versions older than Microsoft PowerPoint 2003 might not display correctly. Presentations made on Macintosh computers must be in PowerPoint v.X, 2004 or later versions.
- In your presentation, leave appropriate time for discussion and questions from the participants.

# Local Stores, Restaurants & Services

-  Post Office
-  Cash Dispenser (ATM)
-  Supermarket / Convenience Store
-  Bank
-  English Menu Available

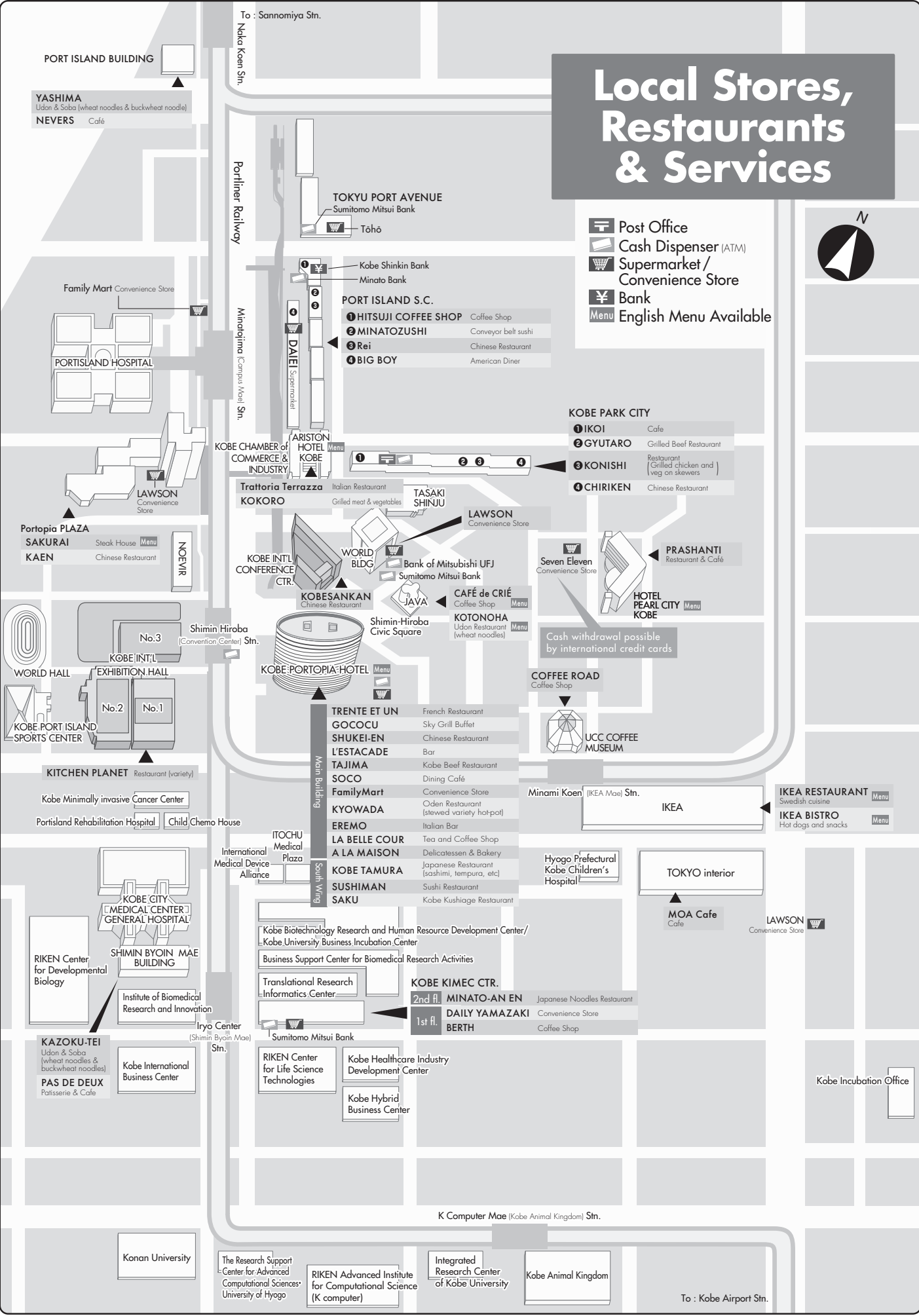

- PORT ISLAND S.C.**
- ① HITSUJI COFFEE SHOP Coffee Shop
  - ② MINATOZUSHI Conveyor belt sushi
  - ③ Rei Chinese Restaurant
  - ④ BIG BOY American Diner
- KOBE PARK CITY**
- ① IKOI Cafe
  - ② GYUTARO Grilled Beef Restaurant
  - ③ KONISHI Restaurant (Grilled chicken and veg on skewers)
  - ④ CHIRIKEN Chinese Restaurant
- COFFEE ROAD** Coffee Shop
- UCC COFFEE MUSEUM**
- MINAMI KOEN (IKEA Mae) Stn.**
- IKEDA RESTAURANT** Swedish cuisine 
- IKEDA BISTRO** Hot dogs and snacks 
- TRENTÉ ET UN** French Restaurant
- GOCOCU** Sky Grill Buffet
- SHUKEI-EN** Chinese Restaurant
- L'ESTACADE** Bar
- TAJIMA SOCO** Kobe Beef Restaurant
- Dining Café**
- FamilyMart** Convenience Store
- KYOWADA** Oden Restaurant (stewed variety hot-pot)
- EREMO** Italian Bar
- LA BELLE COUR** Tea and Coffee Shop
- A LA MAISON** Delicatessen & Bakery
- KOBE TAMURA** Japanese Restaurant (sashimi, tempura, etc)
- SUSHIMAN** Sushi Restaurant
- SAKU** Kobe Kushiage Restaurant
- KOBE KIMEC CTR.**
- 2nd fl. MINATO-AN EN Japanese Noodles Restaurant
  - 1st fl. DAILY YAMAZAKI Convenience Store
  - BERTH Coffee Shop
- Sumitomo Mitsui Bank**
- RIKEN Center for Life Science Technologies**
- Kobe Healthcare Industry Development Center**
- Kobe Hybrid Business Center**
- K Computer Mae (Kobe Animal Kingdom) Stn.**
- Konan University**
- The Research Support Center for Advanced Computational Sciences University of Hyogo**
- RIKEN Advanced Institute for Computational Science (K computer)**
- Integrated Research Center of Kobe University**
- Kobe Animal Kingdom**

# ■ Kobe Portopia Hotel (South Wing)

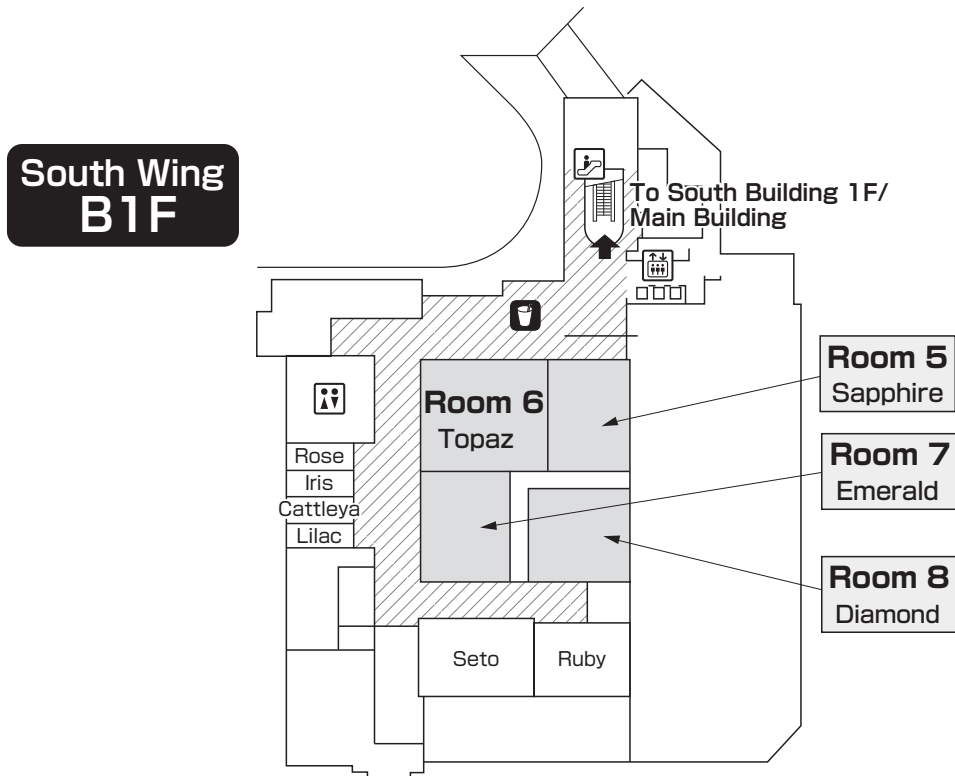
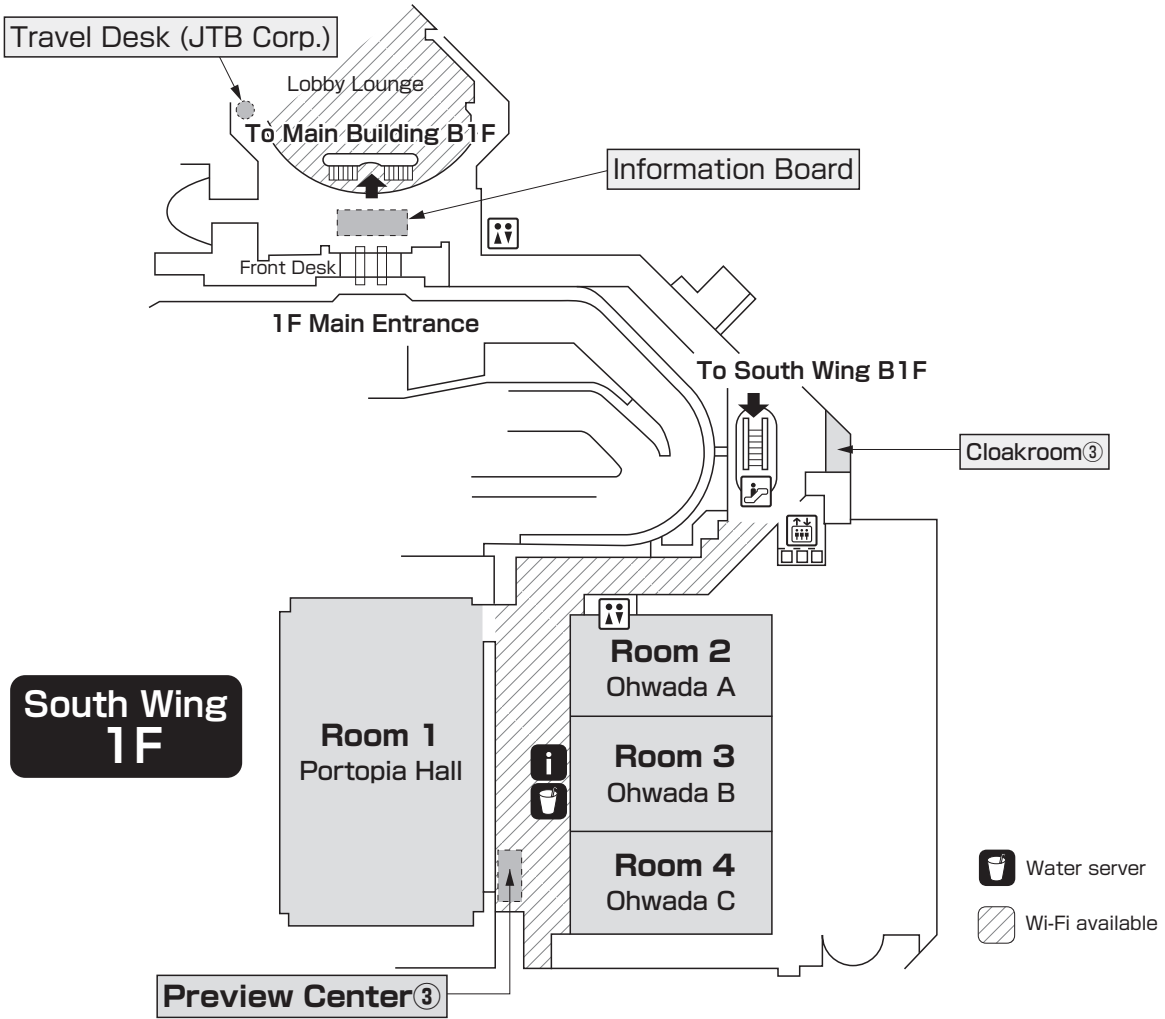



# Kobe Portopia Hotel (Main Building)

## Main Building 2F

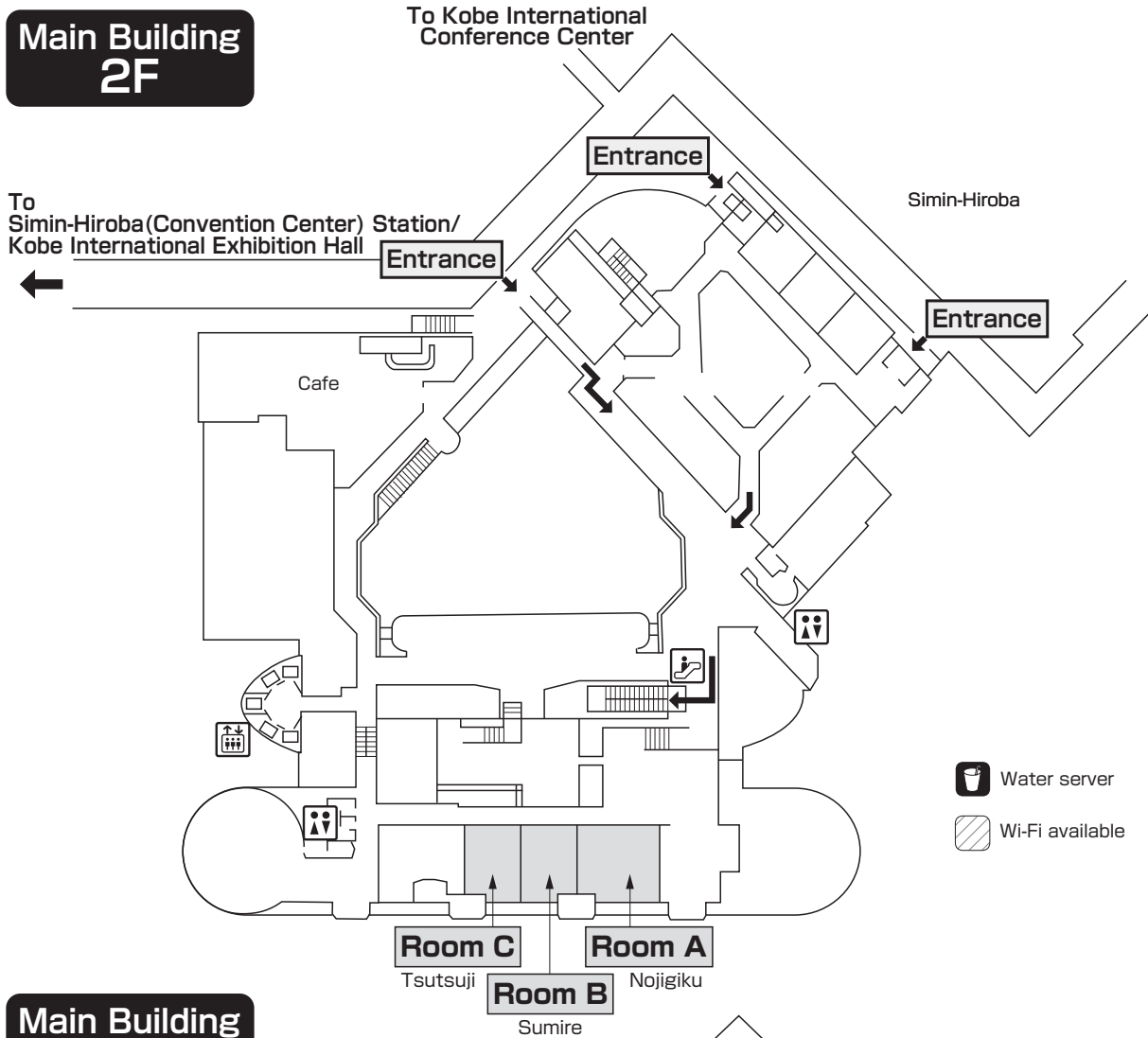

## Main Building B1F

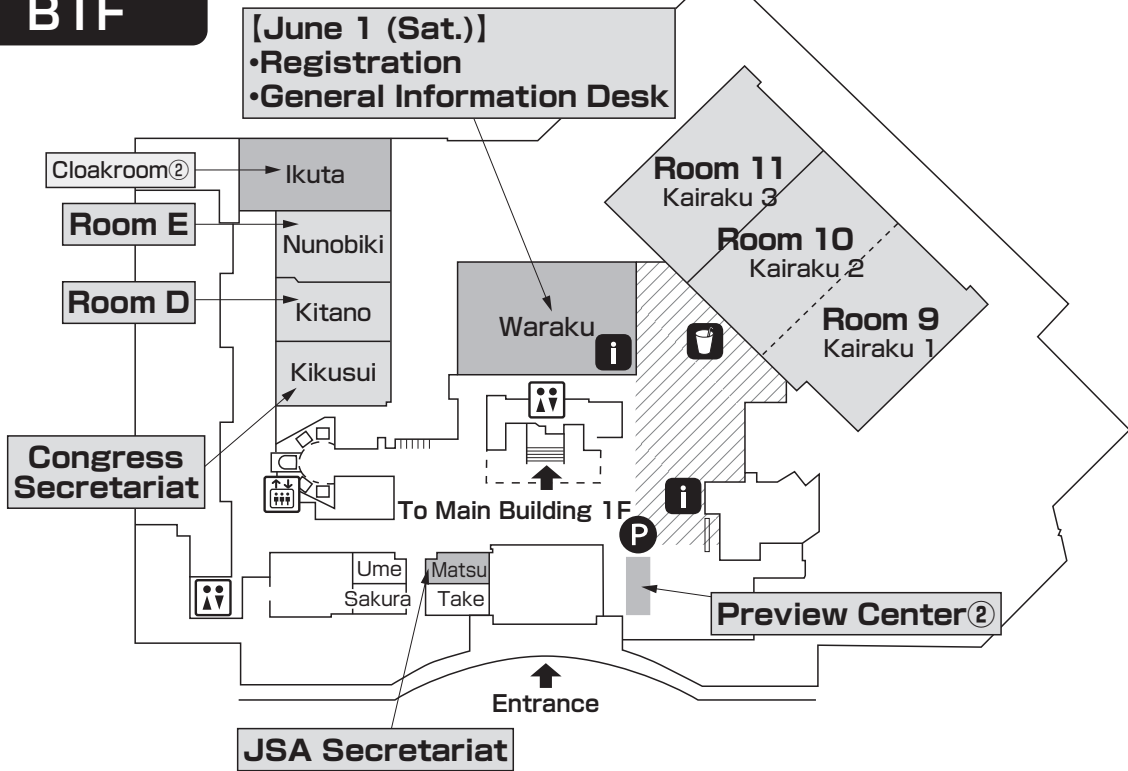

# ■ Kobe International Exhibition Hall (5/30, 5/31)

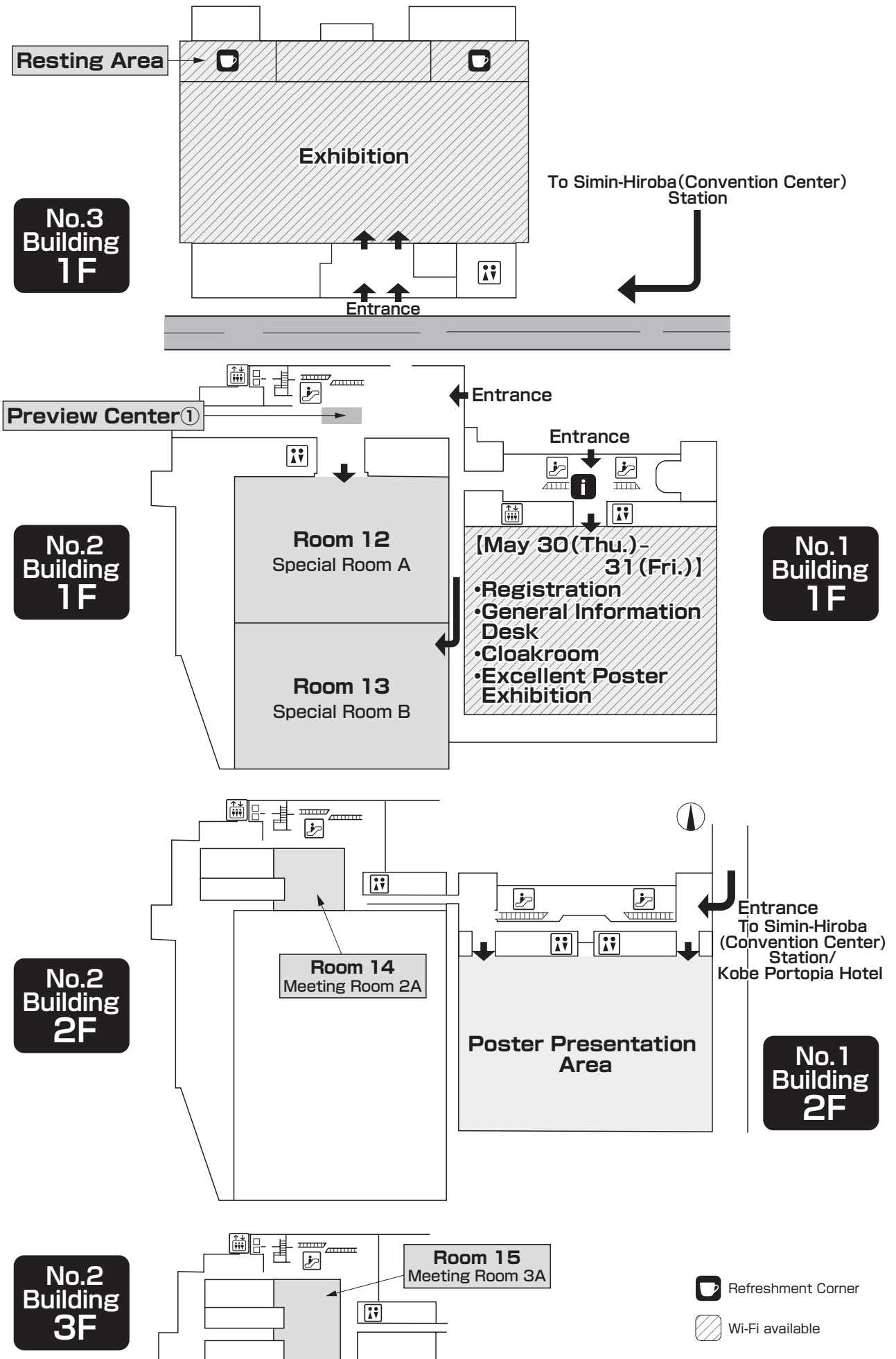

# Kobe International Conference Center (5/30, 5/31)

**1F**

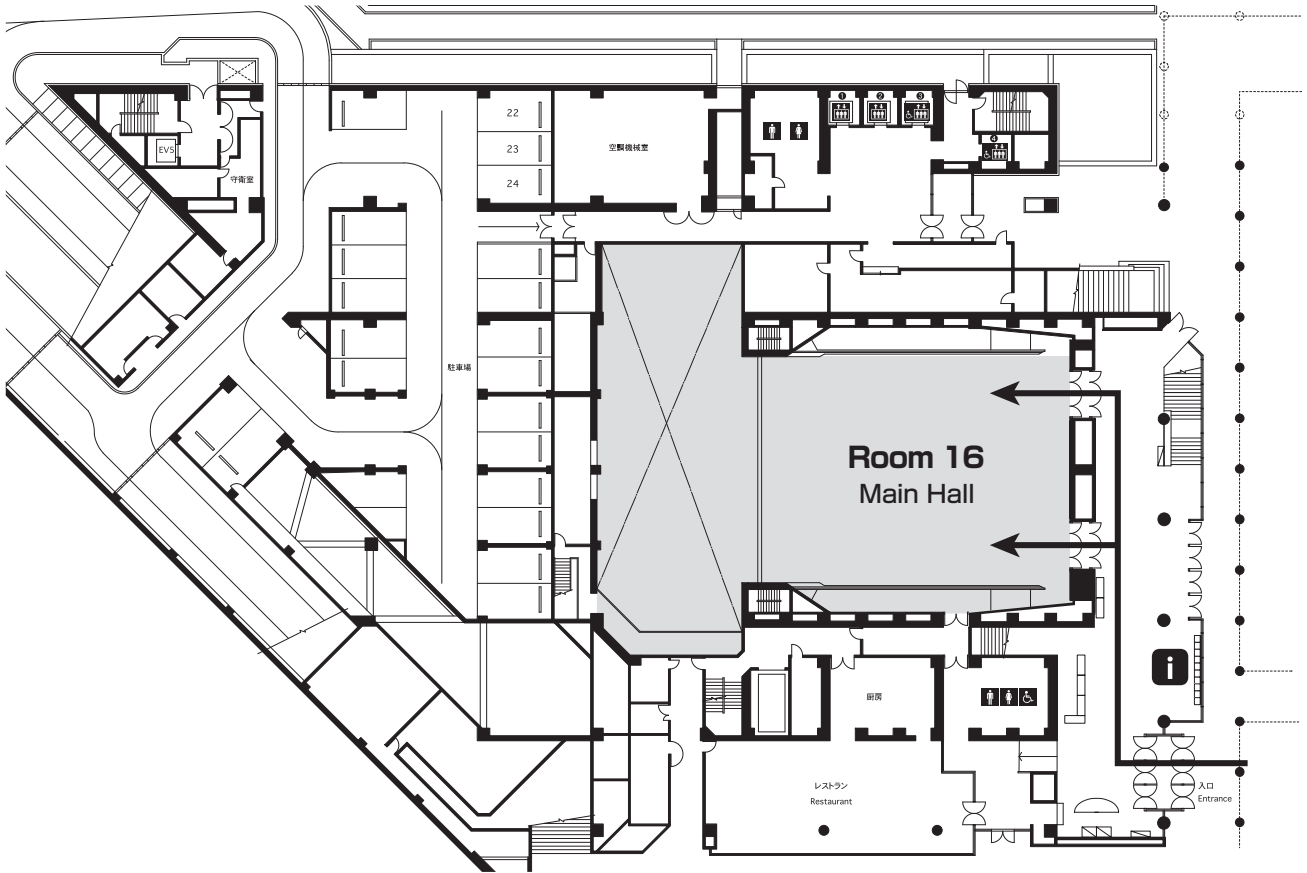

**3F**

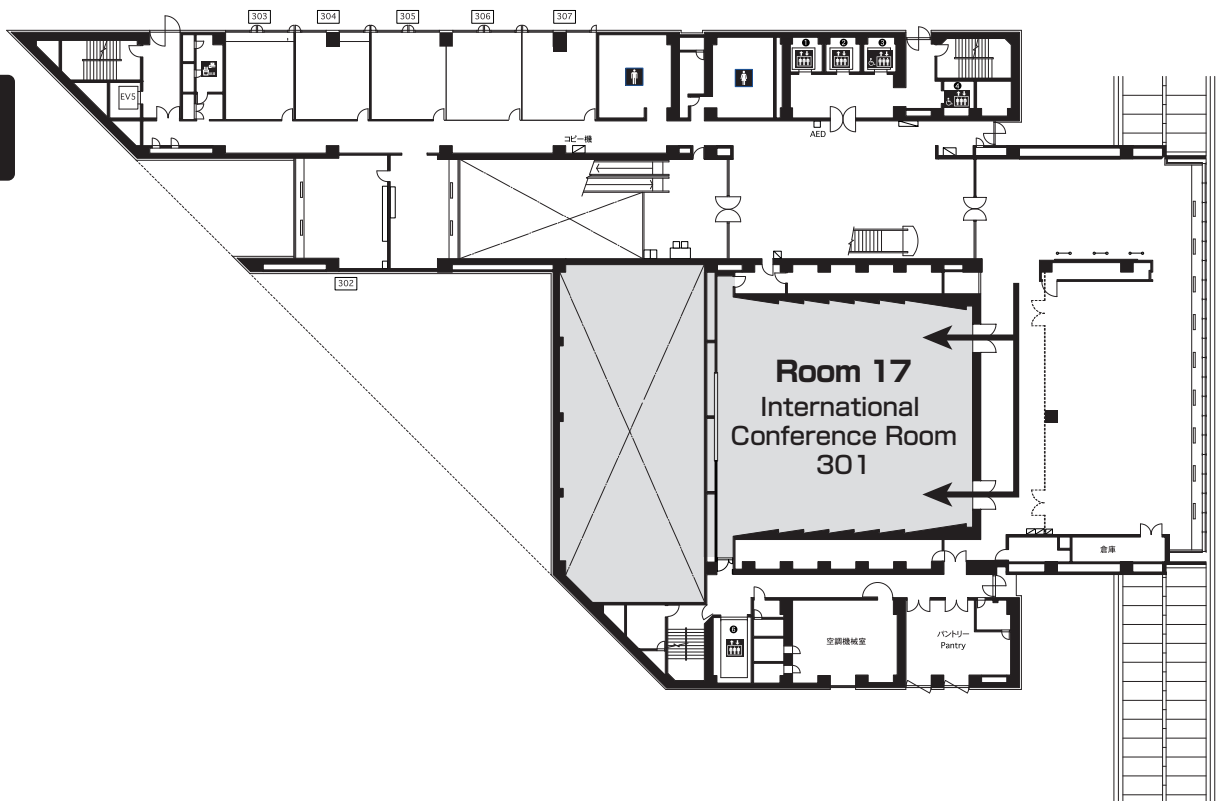

# May 30th (Thu.)

## Poster Discussion Rooms

● Main Building 2F, Kobe Portopia Hotel

● Main Building B1F, Kobe Portopia Hotel

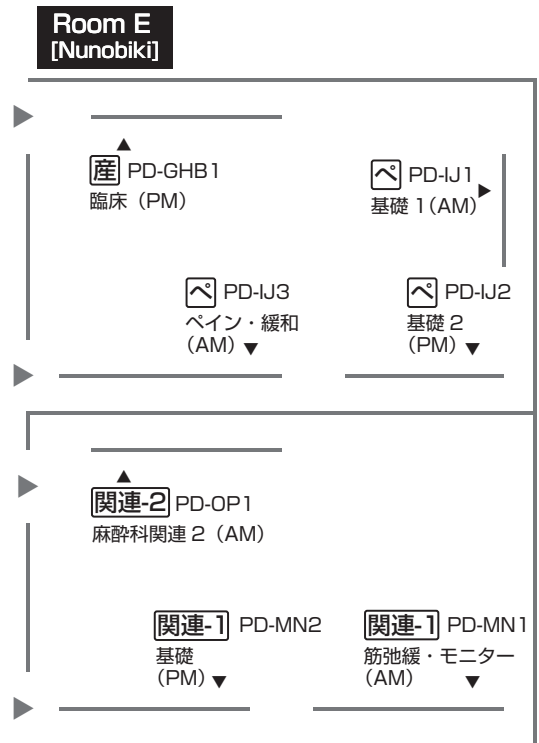
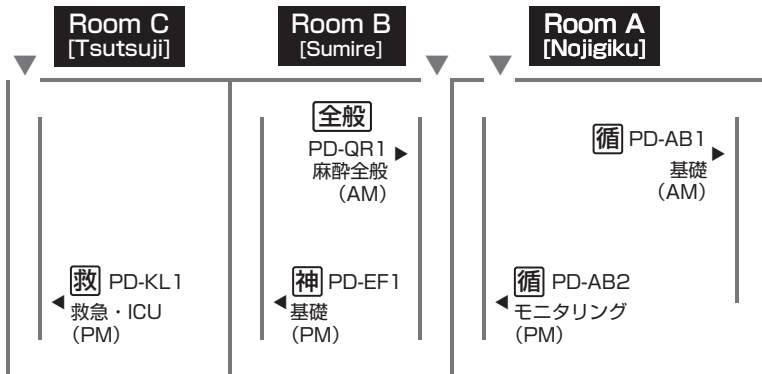

[Presentation time slot] AM 9:30~11:00  
 PM 13:30~15:00

【領域分類/Category】

循	Circulation	へ	Pain Medicine/ Regional Anesthesia/Palliative care
呼	Respiration	救	Emergency Medicine/ICU
神	Neurosciences	関連-1	Anesthesia-related 1
児	Pediatric Anesthesia	関連-2	Anesthesia-related 2
産	Obstetric Anesthesia	全般	Anesthesia in General

## Poster Presentation Area

● No.1 Building 2F, Kobe International Exhibition Hall

[Presentation time slot] ▲ 15:30~16:30  
 ◀ 10:00~11:00

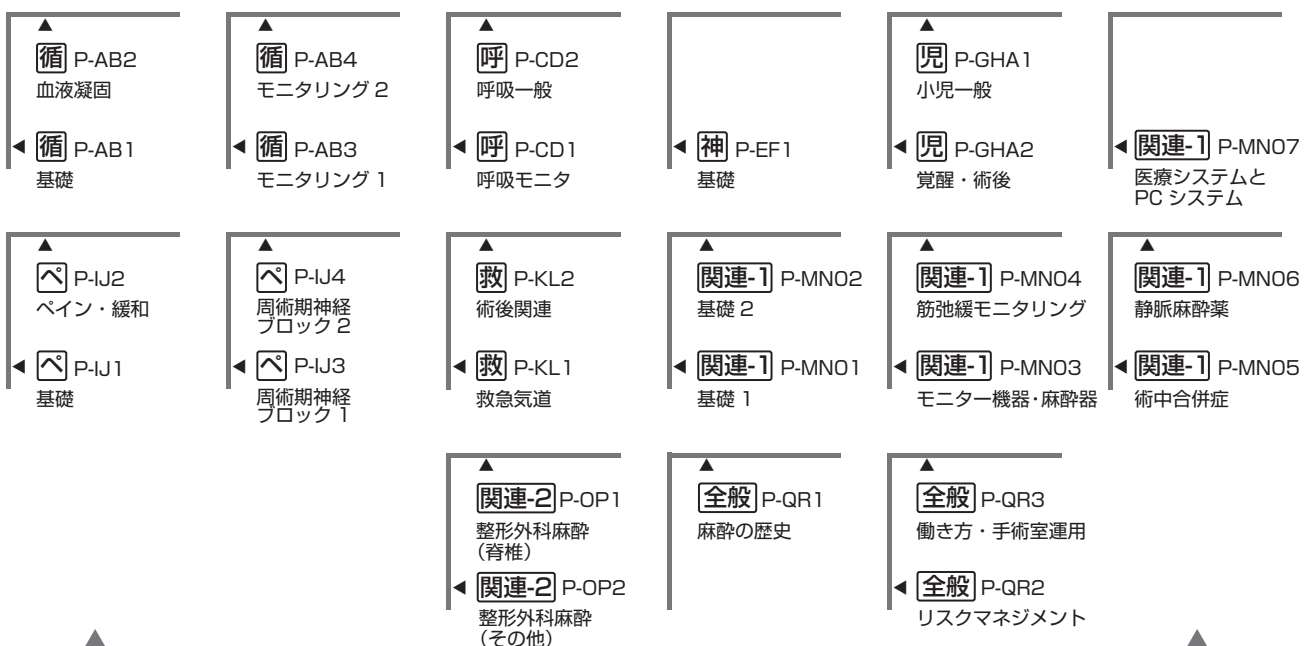

## Poster Discussion Rooms

●Main Building 2F, Kobe Portopia Hotel

●Main Building B1F, Kobe Portopia Hotel

**Room C [Tsutsumi]**

**Room B [Sumire]**

**Room A [Nojigiku]**

**Room E [Nunobiki]**

**Room D [Kitano]**

**【Presentation time slot】** AM 9:30~11:00  
PM 13:30~15:00

**【領域分類/Category】**

循	Circulation	△	Pain Medicine/ Regional Anesthesia/Palliative care
呼	Respiration	救	Emergency Medicine/ICU
神	Neurosciences	関連-1	Anesthesia-related 1
児	Pediatric Anesthesia	関連-2	Anesthesia-related 2
産	Obstetric Anesthesia	全般	Anesthesia in General

## Poster Presentation Area

●No.1 Building 2F, Kobe International Exhibition Hall

**【Presentation time slot】** ▲ 15:30~16:30  
◀ 10:00~11:00

▲ 循 P-AB6  
麻酔管理 1

▲ 循 P-AB8  
TAVI

▲ 呼 P-CD4  
気道管理器具

▲ 神 P-EF2  
臨床

▲ 産 P-GHB2  
臨床 (研究)

▲ 産 P-GHB1  
臨床 (症例)

◀ 循 P-AB5  
成人心臓血管外科手術

◀ 循 P-AB7  
麻酔管理 2

◀ 呼 P-CD3  
気道管理法

◀ 呼 P-CD5  
胸部外科手術の麻酔

◀ 児 P-GHA3  
気道管理・区域麻酔

◀ 産 P-GHB1  
臨床 (症例)

▲ △ P-IJ6  
硬膜外鎮痛法 2

▲ △ PSIN-IJ1  
International Session

▲ 関連-1 P-MN08  
呼吸系合併症

▲ 関連-1 P-MN10  
術前評価 2

▲ 関連-1 P-MN12  
術後評価 2

▲ 関連-1 PSIN-MN1  
International Session

◀ △ P-IJ5  
硬膜外鎮痛法 1

◀ △ P-IJ7  
静脈内鎮痛

◀ 救 P-KL3  
その他

◀ 関連-1 P-MN09  
術前評価 1

◀ 関連-1 P-MN11  
術後評価 1

◀ 関連-1 P-MN13  
血液・体液

▲ 関連-2 P-OP4  
頭頸部の麻酔など

▲ 関連-2 P-OP6  
診療技術・手技など

▲ 全般 P-QR5  
災害

◀ 関連-2 P-OP3  
泌尿器科手術など

◀ 関連-2 P-OP5  
高齢者麻酔

◀ 全般 P-QR4  
麻酔全般

## Program Timetable of English Speakers

Date	Time	Session No.	Session		Place	
30-May	8:30am } 9:30am	C01	Invited Lecture	"Helsinki Declaration on Patient Safety in Anaesthesiology" and its translation into routine clinical practice	Room 1	South Wing, Kobe Portopia Hotel 1F Portopia Hall
	8:30am } 9:30am	IO01	Invited Lecture	Neuroanaesthesia in Bangladesh	Room 2	South Wing, Kobe Portopia Hotel 1F Ohwada A
	8:30am } 9:30am	IO04	Invited Lecture	Recent Cardiovascular Topics in Anesthesia and Critical Care Medicine. A short review	Room 10	Main Building, Kobe Portopia Hotel B1F Kairaku 2
	9:40am } 10:40am	C02	Invited Lecture	Patient Safety and What It Means to the ASA	Room 1	South Wing, Kobe Portopia Hotel 1F Portopia Hall
	9:40am } 10:40am	C06	Invited Lecture	Update on Interfascial Plane Blocks: Anatomical Concepts, Mechanisms, Indications and Techniques	Room 2	South Wing, Kobe Portopia Hotel 1F Ohwada A
	10:30am } 11:30am	IO05	Invited Lecture	SEPSIS-3 and the future	Room 10	Main Building, Kobe Portopia Hotel B1F Kairaku 2
	10:50am } 11:50am	C03	Invited Lecture	The Key Role of Anesthesia Leadership in the Journey to High-Reliability Perioperative Outcomes	Room 1	South Wing, Kobe Portopia Hotel 1F Portopia Hall
	10:50am } 11:50am	C07	Invited Lecture	Epidurals and Spinal Anesthesia: Is Ultrasound the Key to Success?	Room 2	South Wing, Kobe Portopia Hotel 1F Ohwada A
	12:00pm } 1:00pm	L1-02	Sponsored Seminar	Intraoperative hypotension matters	Room 2	South Wing, Kobe Portopia Hotel 1F Ohwada A
	12:00pm } 1:00pm	L1-17	Sponsored Seminar	Beyond Enhanced Recovery After Surgery: Improving Brain Health	Room 17	Kobe International Conference Center 3F International Conference Room
	1:20pm } 2:20pm	IO06	Invited Lecture	Clinical Electroencephalography for Anesthesiologists	Room 10	Main Building, Kobe Portopia Hotel B1F Kairaku 2
	1:30pm } 2:30pm	IO02	Invited Lecture	Sedation outside of the operating room historical review and what is new	Room 2	South Wing, Kobe Portopia Hotel 1F Ohwada A
	1:30pm } 4:30pm	EA	The 7th Meeting of East Asian Congress for Anesthesiologists (EACA)	The 7th Meeting of East Asian Congress for Anesthesiologists (EACA)	Room 17	Kobe International Conference Center 3F International Conference Room
	2:30pm } 3:30pm	IO07	Invited Lecture	The evolution of robotic surgery: surgical and anaesthetic aspects	Room 10	Main Building, Kobe Portopia Hotel B1F Kairaku 2
	3:40pm } 4:40pm	IO03	Invited Lecture	Anticoagulation for laboring women: Society for Obstetric Anesthesia and Perinatology Consensus Statement on Anesthetic Management of Pregnant and Postpartum Women Receiving Anticoagulants	Room 2	South Wing, Kobe Portopia Hotel 1F Ohwada A
	3:40pm } 4:40pm	IO08	Invited Lecture	Apnoeic Oxygenation in OR	Room 10	Main Building, Kobe Portopia Hotel B1F Kairaku 2
5:10pm } 6:10pm	K02	Invited Lecture	What can Journals do to combat scientific misconduct and data fabrication?	Room 10	Main Building, Kobe Portopia Hotel B1F Kairaku 2	

Date	Time	Session No.	Session		Place	
31-May	9:20am } 11:20am	T08	Invited Lecture	The development of Chinese modern anesthesiology	Room 10	Main Building, Kobe Portopia Hotel B1F Kairaku 2
	9:30am } 10:30am	C09	Invited Lecture	Can anaesthesia and analgesia technique during cancer surgery influence oncological outcomes ?	Room 1	South Wing, Kobe Portopia Hotel 1F Portopia Hall
	9:30am } 11:30am	S06	Symposium	Hydrogen: a novel therapeutic modality	Room 3	South Wing, Kobe Portopia Hotel 1F Ohwada B
	10:30am } 11:30am	C13	Invited Lecture	RENAL OXYGENATION ON CARDIOPULMONARY BYPASS AND RISK OF POST OPERATIVE ACUTE KIDNEY INJURY	Room 2	South Wing, Kobe Portopia Hotel 1F Ohwada A
	10:40am } 11:40am	C10	Invited Lecture	Cancer cell biology of anaesthetics	Room 1	South Wing, Kobe Portopia Hotel 1F Portopia Hall
	12:00pm } 1:00pm	L2-17	Sponsored Seminar	Actual lung recruitment procedure during general anesthesia and valuable data secondary use	Room 17	Kobe International Conference Center 3F International Conference Room
	1:20pm } 2:20pm	C11	Invited Lecture	Oncoanesthesiology as a specialty: Time is now	Room 1	South Wing, Kobe Portopia Hotel 1F Portopia Hall
	2:30pm } 4:30pm	C12	Symposium	Perioperative Management of the Cancer Patient	Room 1	South Wing, Kobe Portopia Hotel 1F Portopia Hall
	2:40pm } 3:40pm	IO09	Invited Lecture	<b>(CANCELED)</b> Biology of sodium channel for the chronic pain	Room 2	South Wing, Kobe Portopia Hotel 1F Ohwada A
	3:30pm } 4:30pm	PSIN-IJ1	International Session (Poster Presentation)	Pain Medicine/Regional Anesthesia/Palliative care	Poster Presentation Area	No.1 Building, Kobe International Exhibition Hall 2F Exhibition Hall
	3:30pm } 4:30pm	PSIN-MN1	International Session (Poster Presentation)	Anesthesia-related1	Poster Presentation Area	No.1 Building, Kobe International Exhibition Hall 2F Exhibition Hall

Date	Time	Session No.	Session		Place	
1-June	9:30am } 11:30am	T13	Symposium	International Programs for Asian Countries	Room 10	Main Building, Kobe Portopia Hotel B1F Kairaku 2
	10:40am } 11:40am	C16	Invited Lecture	Myocardial Protection	Room 2	South Wing, Kobe Portopia Hotel 1F Ohwada A
	12:00pm } 1:00pm	L3-10	Sponsored Seminar	Management of the Obsteric Airway-a UK perspective	Room 10	Main Building, Kobe Portopia Hotel B1F Kairaku 2

C01 Invited Lecture

Room 1 South Wing, Kobe Portopia Hotel 1F Portopia Hall

**“Helsinki Declaration on Patient Safety in Anaesthesiology” and its translation into routine clinical practice**

May 30 (THU) 8:30am~9:30am

Chairperson: Yoshito Shiraishi (Shimada Municipal Hospital)

Speaker: Benedikt Preckel (Amsterdam University Medical Centers, location AMC)

I001 Invited Lecture

Room 2 South Wing, Kobe Portopia Hotel 1F Ohwada A

**Neuroanaesthesia in Bangladesh**

May 30 (THU) 8:30am~9:30am

Chairperson: Masahiko Kawaguchi (Nara Medical University)

Speaker: AKM Akhtaruzzaman (Department of Anaesthesia, Analgesia and Intensive Care Medicine, Sheikh Mujib Medical University)

I004 Invited Lecture

Room 10 Main Building, Kobe Portopia Hotel B 1F Kairaku 2

**Recent Cardiovascular Topics in Anesthesia and Critical Care Medicine. A short review**

May 30 (THU) 8:30am~9:30am

Chairperson: Hirotsugu Okamoto (Kitasato University)

Speaker: Marcin Wasowicz (Dept. of Anesthesia Toronto General Hospital and University of Toronto, Cardiovascular Intensive Care Unit at Toronto General hospital)

C02 Invited Lecture

Room 1 South Wing, Kobe Portopia Hotel 1F Portopia Hall

**Patient Safety and What It Means to the ASA**

May 30 (THU) 9:40am~10:40am

Chairperson: Eiichi Inada (Juntendo University)

Speaker: Fred E. Shapiro (Chair of the ASA Committee on Patient Safety)

C06 Invited Lecture

Room 2 South Wing, Kobe Portopia Hotel 1F Ohwada A

**Update on Interfascial Plane Blocks : Anatomical Concepts, Mechanisms, Indications and Techniques**

May 30 (THU) 9:40am~10:40am

Chairperson: Tatsuo Nakamoto (Kansai Medical University)

Speaker: Michael Barrington (Department of Anaesthesia and Acute Pain Medicine University of Melbourne)

I005 Invited Lecture

Room 10 Main Building, Kobe Portopia Hotel B 1F Kairaku 2

**SEPSIS-3 and the future**

May 30 (THU) 10:30am~11:30am

Chairperson: Nobuaki Shime (Hiroshima University)

Speaker: Rob Fowler (Institute of Health Policy, Management and Evaluation University of Toronto)

C03 Invited Lecture

Room 1 South Wing, Kobe Portopia Hotel 1F Portopia Hall

**The Key Role of Anesthesia Leadership in the Journey to High-Reliability Perioperative Outcomes**

May 30 (THU) 10:50am~11:50am

Chairperson: Kimitoshi Nishiwaki (Nagoya University)

Speaker: Paul Barach (Wayne State University School of Medicine/Jefferson College of Population Health)



---

C07 Invited Lecture

Room 2 South Wing, Kobe Portopia Hotel 1F Ohwada A

---

**Epidurals and Spinal Anesthesia :  
Is Ultrasound the Key to Success?**

May 30 (THU) 10:50am~11:50am

Chairperson: Shinichi Sakura (Shimane University)

Speaker: Manoj Kumar Karmakar (The Chinese University of Hong Kong)

---

L1-02 Sponsored Seminar [Sponsored by Edwards Lifesciences Ltd.]

Room 2 South Wing, Kobe Portopia Hotel 1F Ohwada A

---

**Intraoperative hypotension matters**

May 30 (THU) 12:00pm~1:00pm

Chairperson: Makoto Ozaki (Tokyo Women's Medical University)

Perioperative Myocardial Injury

Speaker: Kamal Maheshwari (Cleveland Clinic Foundation)

Should we embrace new technology to treat or prevent intraoperative hypotension?

Speaker: Shoichi Uezono (The Jikei University, School of Medicine)

---

L1-17 Sponsored Seminar [Sponsored by Covidien Japan Inc.]

Room 17 Kobe International Conference Center 3F International Conference Room

---

**Beyond Enhanced Recovery After Surgery :  
Improving Brain Health**

May 30 (THU) 12:00pm~1:00pm

Chairperson: Eiichi Inada (Juntendo University)

Speaker: Vijaya Gottumukkala (The University of Texas MD Anderson Cancer Center)

---

I006 Invited Lecture

Room 10 Main Building, Kobe Portopia Hotel B 1F Kairaku 2

---

**Clinical Electroencephalography for Anesthesiologists**

May 30 (THU) 1:20pm~2:20pm

Chairperson: Tsunehisa Tsubokawa (The Jikei University)

Speaker: Emery N. Brown (Massachusetts Institute of Technology)

---

I002 Invited Lecture

Room 2 South Wing, Kobe Portopia Hotel 1F Ohwada A

---

**Sedation outside of the operating room historical review  
and what is new**

May 30 (THU) 1:30pm~2:30pm

Chairperson: Hiroshi Otake (Showa University)

Speaker: Charles J. Coté (Anaesthesia Harvard Medical School)

---

**EA The 7th Meeting of East Asian Congress for Anesthesiologists (EACA)**

Room 17 Kobe International Conference Center 3F International Conference Room

**The 7th Meeting of East Asian Congress  
for Anesthesiologists (EACA)**

May 30 (THU) 1:30pm~4:30pm

Chairperson: Eiichi Inada (Juntendo University)  
Yuichi Kanmura (Kagoshima University)

Simulation, Education, and Innovation

Speaker: Kiyoyuki Miyasaka (St. Luke's International University and Hospital)

An Obstetric Anesthetic education for young Anesthesiologists in Japan

Speaker: Chiyo Ootaki (Osaka University graduate school of medicine)

Introduction and Effectiveness of the Rapid Response System for Patient Safety

Speaker: Masayuki Kuroiwa (Kitasato University School of Medicine)

Non-vitamin K antagonist anticoagulants : the anesthesiologists concern

Speaker: Ann Youn (Chungnam National University College of Medicine)

High flow nasal oxygen therapy

Speaker: Hyun Joo Kim (Yonsei University College of Medicine)

Acute kidney injury in cardiac surgery

Speaker: Young Lan Kwak (Yonsei University College of Medicine)

**1007 Invited Lecture**

Room 10 Main Building, Kobe Portopia Hotel B1F Kairaku 2

**The evolution of robotic surgery :  
surgical and anaesthetic aspects**

May 30 (THU) 2:30pm~3:30pm

Chairperson: Tomoko Yorozu (Kyorin University)

Speaker: Hutan Ashrafian (Institute of Global Health Innobation, Imperial College London, UK)

**1003 Invited Lecture**

Room 2 South Wing, Kobe Portopia Hotel 1F Ohwada A

**Anticoagulation for laboring women :**

May 30 (THU) 3:40pm~4:40pm

**Society for Obstetric Anesthesia and Perinatology Consensus Statement on An-  
esthetic Management of Pregnant and Postpartum Women Receiving Antico-  
agulants**

Chairperson: Yasuko Nagasaka (St. Luke's International Hospital)

Speaker: Lisa R. Leffert (Harvard Medical School, Massachusetts General Hospital, Boston, MA USA)

**1008 Invited Lecture**

Room 10 Main Building, Kobe Portopia Hotel B1F Kairaku 2

**Apnoeic Oxygenation in OR**

May 30 (THU) 3:40pm~4:40pm

Chairperson: Shuya Kiyama (The Jikei University)

Speaker: Anil Patel (The Royal National Throat Nose and Ear Hospital, London, UK)

**K02 Invited Lecture**

Room 10 Main Building, Kobe Portopia Hotel B1F Kairaku 2

**What can Journals do to combat scientific misconduct  
and data fabrication?**

May 30 (THU) 5:10pm~6:10pm

Chairperson: Michiaki Yamakage (Sapporo Medical University)

Speaker: Andrew A. Klein (Royal Papworth Hospital, University of Cambridge)

T08 Invited Lecture

Room 10 Main Building, Kobe Portopia Hotel B1F Kairaku 2

**The development of Chinese modern anesthesiology**

May 31 (FRI) 9:20am~11:20am

Chairperson: Kentaroh Dote (Ehime University)

Hiroshi Makino (Hamamatsu University)

Speaker: Li Sheng Zhang (Fourth Affiliated Hospital, Hebei Medical University, Shijiazhuang, Hebei, China)

C09 Invited Lecture

Room 1 South Wing, Kobe Portopia Hotel 1F Portopia Hall

**Can anaesthesia and analgesia technique during cancer surgery influence oncological outcomes ?**

May 31 (FRI) 9:30am~10:30am

Chairperson: Kazuyoshi Hirota (Hirosaki University)

Speaker: Donal Buggy (Mater University Hospital, University College Dublin)

S06 Symposium

Room 3 South Wing, Kobe Portopia Hotel 1F Ohwada B

**Hydrogen : a novel therapeutic modality**

May 31 (FRI) 9:30am~11:30am

Chairperson: Kiyonobu Nishikawa (Osaka City University Hospital)

Potential of Hydrogen Therapy in Sepsis

Speaker: Yonghao Yu (Tianjin Medical University General Hospital, Tianjin, China.)

Clinical application of molecular hydrogen

Speaker: Yasushi Satoh (National Defense Medical College, Departments in the School of Medicine)

The Potential of Hydrogen Gas as a Novel Medical Gas

Speaker: Tomoyoshi Tamura (Emergency and Critical Care Medicine, Keio University School of Medicine)

Clinical trial of simultaneous nitric oxide and hydrogen gas inhalation therapy for patients with acute myocardial infarction

Speaker: Kenichi Kokubo (Kitasato University School of Allied Health Sciences)

C13 Invited Lecture

Room 2 South Wing, Kobe Portopia Hotel 1F Ohwada A

**RENAL OXYGENATION ON CARDIOPULMONARY BYPASS AND RISK OF POST OPERATIVE ACUTE KIDNEY INJURY**

May 31 (FRI) 10:30am~11:30am

Chairperson: Motoshi Kainuma (Inazawa Municipal Hospital)

Speaker: Roger G. Evans (Monash University)

C10 Invited Lecture

Room 1 South Wing, Kobe Portopia Hotel 1F Portopia Hall

**Cancer cell biology of anaesthetics**

May 31 (FRI) 10:40am~11:40am

Chairperson: Kazuhiko Fukuda (Kyoto University)

Speaker: Daqing Ma (Imperial College London)

---

**L2-17 Sponsored Seminar** [Sponsored by GE Healthcare Japan]

Room 17 Kobe International Conference Center 3F International Conference Room

---

**Actual lung recruitment procedure during general anesthesia and valuable data secondary use**

May 31 (FRI) 12:00pm~1:00pm

Chairperson: Takayuki Kitamura (Toho University Sakura Medical Center)

Speaker: Yuka Matsuki (Department of Anesthesiology & Reanimatology, University of Fukui, Faculty of Medicine Sciences, Fukui, Japan)

Speaker: Brandon Henak (Anesthesia & Respiratory Global Product Marketing GE Healthcare)

---

**C11 Invited Lecture**

Room 1 South Wing, Kobe Portopia Hotel 1F Portopia Hall

---

**Oncoanesthesiology as a specialty : Time is now**

May 31 (FRI) 1:20pm~2:20pm

Chairperson: Kimitoshi Nishiwaki (Nagoya University)

Speaker: Vijaya Gottumukkala (The University of Texas MD Anderson Cancer Center)

---

**C12 Symposium**

Room 1 South Wing, Kobe Portopia Hotel 1F Portopia Hall

---

**Perioperative Management of the Cancer Patient**

May 31 (FRI) 2:30pm~4:30pm

Chairperson: Kazuyoshi Hirota (Hirosaki University)

Commentator: Donal Buggy (University College Dublin)

Vijaya Gottumukkala (The University of Texas MD Anderson Cancer center)

Does anaesthesia management contribute to the long term outcomes of cancer patients?

Speaker: Daqing Ma (Imperial College London)

Cancer recurrence : Type of anesthesia matters?

Speaker: Jin-Tae Kim (Seoul National University College of Medicine, Seoul Korea)

Low-dose sevoflurane induced proliferation through ERK phosphorylation in colon cancer cell lines

Speaker: Yuko Konishi (Endowed Division of Perioperative Management, Nagoya University Graduate School of Medicine)

What is the best combination of intravenous anesthetics for cancer surgery?

Speaker: Hidetomo Niwa (Department of anesthesiology, Hirosaki university hospital)

---

**I009 Invited Lecture**

Room 2 South Wing, Kobe Portopia Hotel 1F Ohwada A

---

**(CANCELED) Biology of sodium channel for the chronic pain**

May 31 (FRI) 2:40pm~3:40pm

Chairperson: Fumimasa Amaya (Kyoto Prefectural University of Medicine)

Speaker: Isabelle Decosterd (Pain Center, Department of Anesthesiology, Lausanne University Hospital)

---

## PSIN-IJ1 Pain Medicine/Regional Anesthesia/Palliative care

Poster Presentation Area No.1 Building, Kobe International Exhibition Hall 2F Exhibition Hall

---

May 31 (FRI) 3:30pm~4:30pm

Chairperson: Seiji Hattori (Chubu Tokushukai Hospital)

PSIN-IJ1-1 Sensitive RNAscope in situ hybridization and QuPath quantification reveal a much larger population of DRG neurons expressing mu and delta opioid receptors

Speaker: Megumi Matsuda (Center for Translational Pain Medicine, Department of Anesthesiology, Duke University Medical Center/Research Unit for the Neurobiology of Pain, Department of Anesthesiology, Kyoto Prefectural University of Medicine)

PSIN-IJ1-2 withdrawn

PSIN-IJ1-3 The effects of ultrasound-guided serratus plane block on intraoperative opioid consumption, emergence time and hemodynamic stability during video-assisted thoracoscopic lobectomy

Speaker: Saeyoung Kim (Department of Anesthesiology and Pain Medicine, Kyungpook National University)

PSIN-IJ1-4 Antibacterial effect of lidocaine in various clinical conditions

Speaker: Sanghi Park (Department of Anesthesiology and Pain Medicine, Chungbuk National University Hospital)

PSIN-IJ1-5 A retrospective comparison of epidural and intrathecal morphine with subcutaneous port system in palliative cancer patients with refractory pain : Impact on pain relief and complication

Speaker: Eunsoo Kim (Pusan National University)

---

## PSIN-MN1 Anesthesia-related 1

Poster Presentation Area No.1 Building, Kobe International Exhibition Hall 2F Exhibition Hall

---

May 31 (FRI) 3:30pm~4:30pm

Chairperson: Tomasz Hascilowicz (The Jikei University School of Medicine Daisan Hospital)

PSIN-MN1-1 Influences of Propofol and Dexmedetomidine on Proliferation in Esophageal Squamous Cell Carcinoma Cell Lines

Speaker: Rui Zhou (Nagoya University Graduate School of Medicine)

PSIN-MN1-2 Impact of Crystalloid versus Colloid on Postoperative Nausea and Vomiting : Systematic Review and Meta-Analysis of Randomized Trials

Speaker: Myeongjong Lee (Department of Anesthesiology and Pain Medicine, Konkuk University School of Medicine)

PSIN-MN1-3 Comparison of Heart Rate Between Physiological sleep and Dexmedetomidine Sedation

Speaker: Changwoo Lim (Kosin University Gospel Hospital)

PSIN-MN1-4 Use of Anesthetic Depth Monitoring For Sedation During General Anesthesia : Prospective Observational Study

Speaker: Kyu Nam Kim (Department of Anesthesiology and Pain Medicine, Hanyang University Hospital)

PSIN-MN1-5 The Current usage status of neuromuscular blockers and sugammadex in Korea

Speaker: Hong Seuk Yang (Department of Anesthesiology and Pain Medicine, Gangneung Asan Hospital, University of Ulsan, College of Medicine)

PSIN-MN1-6 withdrawn

---

T13 Symposium

Room 10 Main Building, Kobe Portopia Hotel B1F Kairaku 2

---

**International Programs for Asian Countries**

June 1 (SAT) 9:30am~11:30am

Chairperson: Tomoko Yorozu (Kyorin University)  
Mikito Kawamata (Shinshu University)

Partnering with Asian Countries : the Medical Missions for Children Experience

Speaker: Pacifico M. Tuason (Massachusetts General Hospital)

Cardiac Anesthesia in Thailand 4.0 and My clinical experience at Osaka University Hospital

Speaker: Areerat Kaewanuchit (Lerdsin Hospital, Department of Medical Service, Ministry of Public Health, Thailand)

Cardiac anesthesia in Malaysia and medical support in Asia

Speaker: Kenji Doi (Tokyo Women's Medical University Hospital)

From the Island to the World

Speaker: Chihiro Imai

What is our way to go to make an international contribution as a public interest incorporated association?

Speaker: Tomoko Yorozu (Dept. of Anesthesiology, Kyorin University Faculty of Medicine)

---

C16 Invited Lecture

Room 2 South Wing, Kobe Portopia Hotel 1F Ohwada A

---

**Myocardial Protection**

June 1 (SAT) 10:40am~11:40am

Chairperson: Kenji Shigemi (University of Fukui)

Speaker: Daniel Nyhan (Johns Hopkins University, School of Medicine)

---

L3-10 Sponsored Seminar [Sponsored by Japan Medicalnext Co., Ltd.]

Room 10 Main Building, Kobe Portopia Hotel B1F Kairaku 2

---

**Management of the Obsteric Airway-a UK perspective**

June 1 (SAT) 12:00pm~1:00pm

Chairperson: Takashi Asai (Dokkyo Medical University Saitama Medical Center)

Speaker: William John Donaldson (Northern Health and Social Care Trust Consultant Anaesthetist)

# MEMO

# MEMO



# Congress Venue



		Venue	May29 (Wed.)	May30 (Thu.)	May31 (Fri.)	June1 (Sat.)
Registration	①	1F, No.1 Bldg., Exhibition Hall	12:00-19:00	7:30-19:00	7:30-18:30	
	②	B1F, Main Bldg., Portopia Hotel				7:30-16:00
Cloakroom	①	1F, No.1 Bldg., Exhibition Hall			7:30-18:30	
	②	B1F, Main Bldg., Portopia Hotel		7:30-20:00		
	③	1F, South Bldg., Portopia Hotel	10:30-20:30		7:30-20:30	7:30-16:30
PC Preview Center	①	1F, No.2 Bldg., Exhibition Hall				
	②	B1F, Main Bldg., Portopia Hotel		7:30-18:30	7:30-17:00	
	③	1F, South Bldg., Portopia Hotel	17:00-19:00			7:30-15:00

