

## Program at a Glance







**[Day 1] July 18 (Sat.), 2026 Makuhari Messe**

	8:30	9:00	9:30	10:00	10:30	11:00	11:30	12:00	12:30	13:00	
<b>Room1</b> International Conference Hall 2F Convention Hall A	Opening Ceremony	8:30~10:00			10:50~11:50						
		<b>Symposium 1</b> From "Support" to "Connection": The Synergy of Cardiac Rehabilitation and Social Prescribing Chairs : Yutaka Kimura Masataka Sata			<b>Keynote Lecture 1</b> Cardiac Rehabilitation and ICF (International Classification of Functioning, Disability and Health) Chair : Shigeru Makita Speaker : Emiko Oikawa						
<b>Room8</b> International Conference Hall 3F 304	8:30~9:40		9:40~10:50		10:50~12:00		12:10~13:10				
	<b>AsiaPrevent and English Session Oral 1</b> Exercise Therapy & Rehabilitation Chairs : Saari Mohamad Yatim Ssu-Yuan Chen		<b>AsiaPrevent and English Session Oral 2</b> CPX & Physiology Chairs : Ngai Yin Chan Junichi Funada		<b>AsiaPrevent and English Session Oral 3</b> Pathophysiology & Biomarkers Chairs : Kazuhisa Kaneda Shinji Sato		<b>Board Member Meeting</b>				
<b>Poster Room</b> 1F International Exhibition Hall 8	8:30~10:00			10:00~13:25							
	Poster Mounting			Poster Viewing							

## Program at a Glance



**[Day 2] July 19 (Sun.), 2026 Makuhari Messe**

	8:30	9:00	9:30	10:00	10:30	11:00	11:30	12:00	12:30	13:00
<b>Room1</b> International Conference Hall 2F Convention Hall A				9:40~11:10			11:45~12:45			
				<b>Panel Discussion 12</b> Leave no one behind! Toward inclusive cardiac rehabilitation: Practical comprehensive support for socially vulnerable patients Chairs : Ryuji Nohara Toshimi Ikegame			<b>Keynote Lecture 3</b> Cardio-Oncology Rehabilitation: The Next Frontier For Cardiac Rehabilitation Programs Chair : Tetsuya Takahashi Speaker : Peter H. Brubaker, Ph.D.			
<b>Room8</b> International Conference Hall 3F 304				9:40~11:00		11:00~12:30		Award Ceremony		
				<b>AsiaPrevent Expert Lecture</b> Evidence and Practice of Exercise Intensity in Cardiac Rehabilitation Chairs : Yasuhiko Sakata Yutaka Kimura		<b>TACVPR-JACR Joint Symposium</b> Shared Perspectives on Cardiac Rehabilitation Chairs : Ko-Long Lin Yoshihiro Fukumoto				
<b>Poster Room</b> 1F International Exhibition Hall 8				9:30~17:30						
				Poster Viewing						

13:00	13:30	14:00	14:30	15:00	15:30	16:00	16:30	17:00	17:30	18:00	18:30	19:00
		13:25~14:05  <b>Presidential Lecture</b> Chair : Masahiro Kohzuki Speaker : Toshiko Yoshida				15:35~16:35  <b>Symposium 2</b> Improving the Quality of Cardiac Rehabilitation and Generating Evidence Through Society-Led Registry Studies Chairs : Yasuhiko Sakata Masakazu Saitoh		16:50~17:50  <b>Symposium 3</b> Organizing the Evidence Gaps in Cardiac Rehabilitation for Heart Failure Chairs : Hideo Izawa Yuya Matsue				19:00~20:45
			14:35~15:45  <b>AsiaPrevent and English Session Oral 4</b> Heart Failure Chairs : Chan Joo Lee Takayuki Kawamura		15:50~17:00  <b>AsiaPrevent and English Session Moderated Poster</b> Comprehensive Cardiac Care Chairs : Maria Rosan Trani Toshiki Kaihara			17:20~18:20  <b>Keynote Lecture 2</b> Multidisciplinary teams for patients with cardiovascular disease: What is needed? Chair : Toshiko Yoshida Speaker : Leonie Klompstra, Ph.D.				Gala Networking Party @International Exhibition Hall 8 ※Doors Open 18:30
	13:25~14:25	14:25~18:20										
	<b>Poster Presentation</b>		<b>Poster Viewing</b>									

**AsiaPrevent and English Session Poster**

No.	Session Theme	Chair	Time
APP1	Cardiac Rehabilitation	Yuya Yokota Masanori Kanazawa	13:25 ~ 14:25
APP2	Clinical Cases & Physical Therapy	Asami Ogura Masakazu Saitoh	13:25 ~ 14:25
APP3	Epidemiology & Healthcare Systems	Satoshi Kurose Akihiro Hirashiki	13:25 ~ 14:25
APP4	Exercise Capacity & Functional Assessment	Cao Pengyu Makoto Murata	13:25 ~ 14:25
APP5	Heart Failure & Muscle Function	Kushal Madan	13:25 ~ 14:25
APP6	Respiratory Rehabilitation	Ssu-Yuan Chen	13:25 ~ 14:25

13:00	13:30	14:00	14:30	15:00	15:30	16:00	16:30	17:00	17:30	18:00	18:30	19:00
			14:10~15:40  <b>Symposium 9</b> Practices and Challenges in HAD and PICS Management in Cardiac Rehabilitation Chairs : Hirokazu Shiraishi Yuki Iida			16:00~17:30  <b>Symposium 10</b> Cancer and Cardiac Rehabilitation: The Potential of Cardio-Oncology Rehabilitation Chairs : Koji Sakurada Masanobu Yanase			<b>Closing Ceremony</b>			
					15:50~17:10  <b>EAPC/JACR Joint Symposium</b> Cardiac Rehabilitation in the Real World: Addressing Social Determinants of Health Chairs : Ana Abreu Yasuhiko Sakata							
									17:30~18:30			
									<b>Removal</b>			

# Floor Map

## Makuhari Messe International Conference Hall

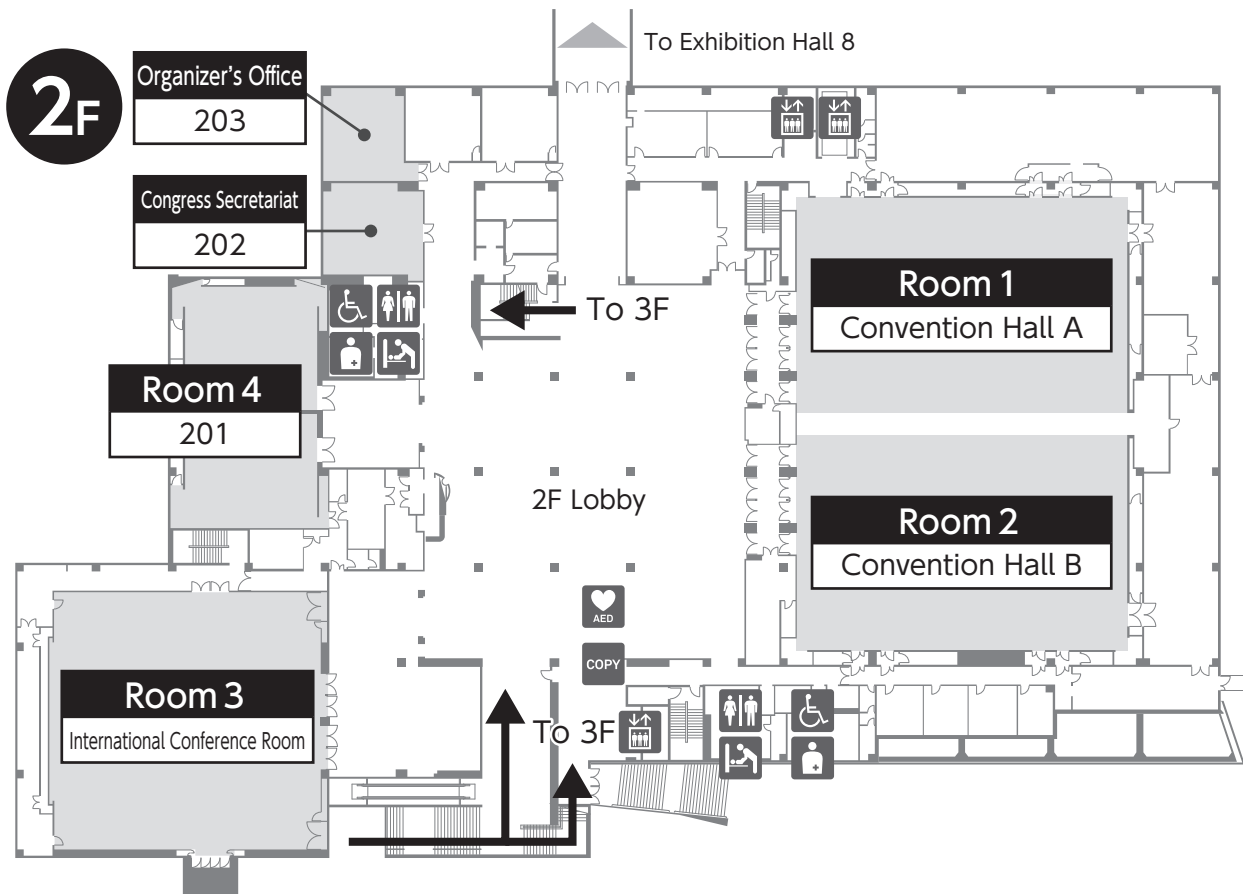
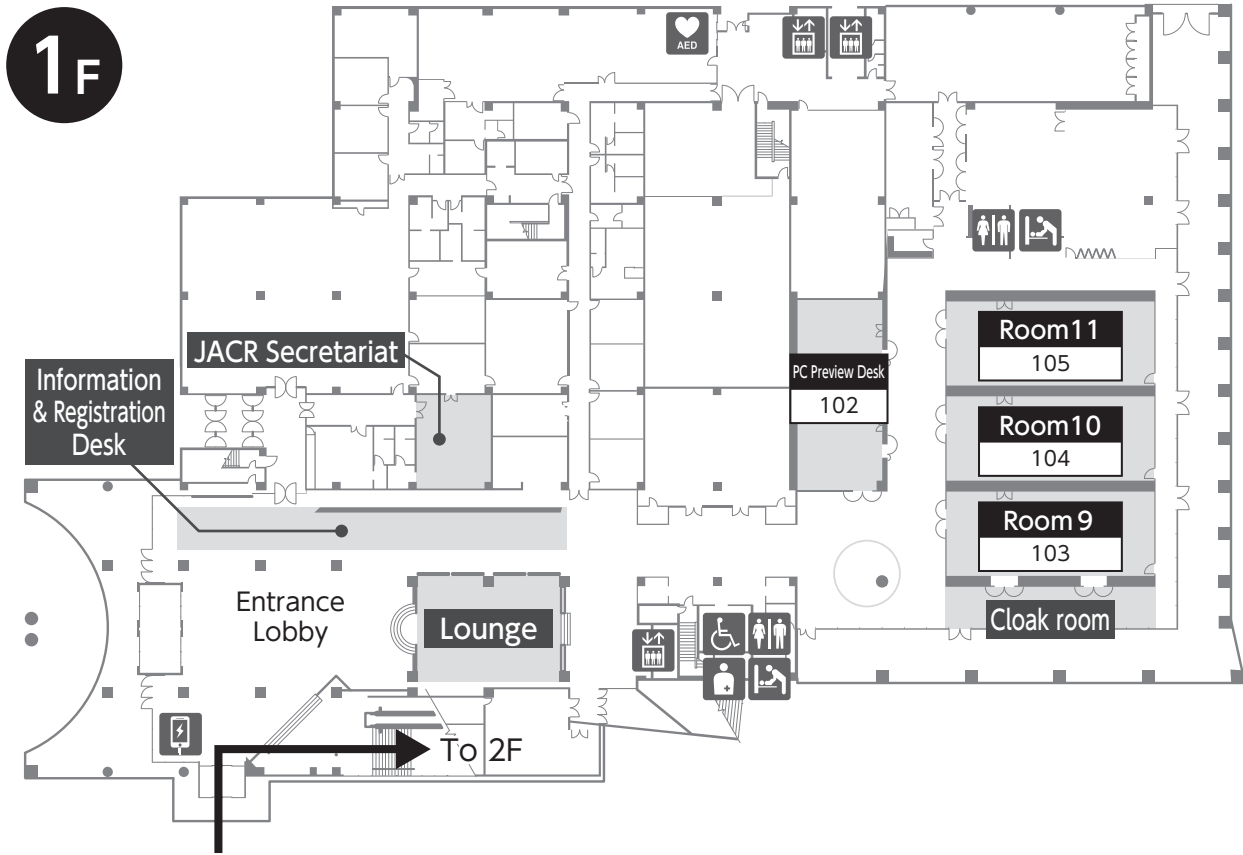

Floor Map

Makuhari Messe International Conference Hall

3F

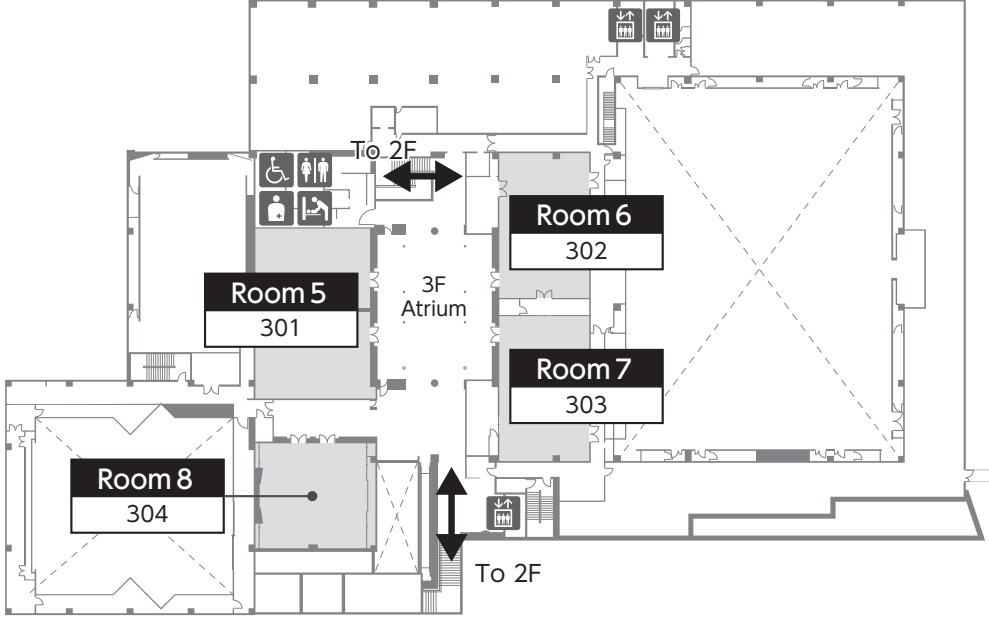

Makuhari Messe  
International  
Exhibition Hall 8

1F

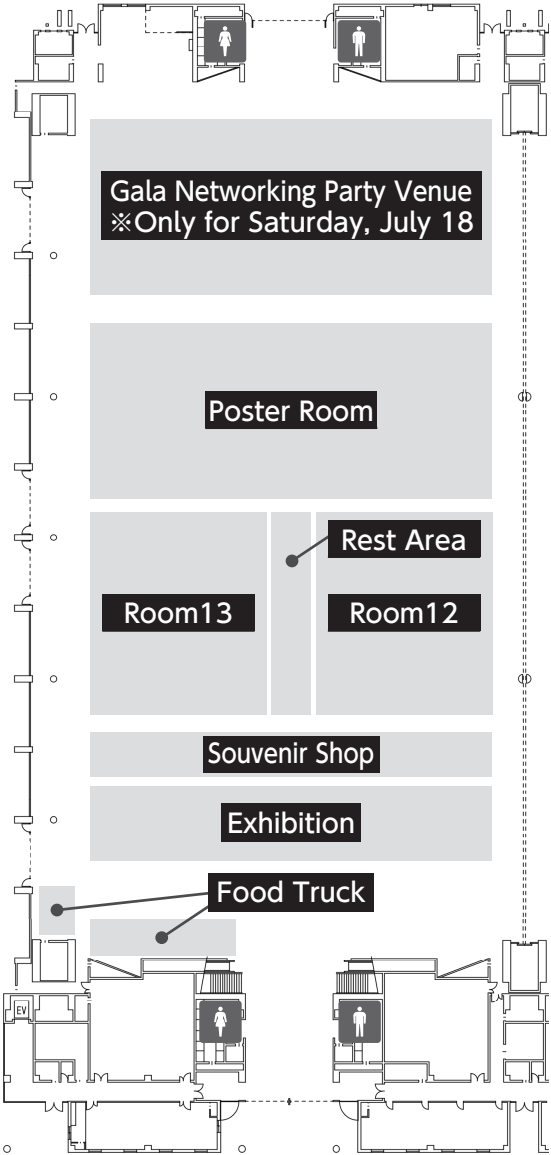

# General Information

## Dates

July 18 (Sat.) – 19 (Sun.), 2026

AsiaPREvent and English Session will be held on both July 18 (Sat.) and July 19 (Sun.).

## Venue

Makuhari Messe

2-1, Nakase, Mihama-ku, Chiba-city, 261-8550 Japan

TEL +81-43-296-0001

## President

Toshiko Yoshida, RN, PHN, PhD

Professor, Graduate School of Nursing Science, St. Luke's International University

## Vice President

Shigeru Makita, MD, PhD

Honorary Professor, Saitama Medical University International Medical Center

Assistant Director, Kawaguchi Cupola Rehabilitation Hospital

Hiroyoshi Yokoi, MD, PhD

Director, Fukuoka Central Hospital

Vice Director of Fukuoka Sanno Hospital and Director of the Cardiovascular Center

Professor, Fukuoka International University of Health and Welfare

## Registration

Registration fees for participants from outside Japan are as follows and will be payable at the venue reception. Please note that the registration fee must be paid in cash on site.

Doctors / Regular	1,000 JPY
Medical Staff / Resident	1,000 JPY
Foreign nationals residing overseas & International graduate students in Japan	1,000 JPY Limited to those with the "Student" residence status. Students must present their student ID at the registration desk as proof of their student status.
Undergraduate Students	Free of Charge Undergraduate students must present their student ID at the registration desk as proof of their student status.

Place: Makuhari Messe, International Conference Hall, 1F Entrance Lobby

7/18 (Sat.) 8:00-18:00

7/19 (Sun.) 8:00-17:00

### **Cloakroom**

Valuables and umbrellas cannot be stored.

Date and Time	Place
7/18 (Sat.) 8:00-21:00	Makuhari Messe, International Conference Hall, 1F
7/19 (Sun.) 8:00-18:00	

### **Rest Area**

Place: Makuhari Messe, 1F, International Exhibition Hall 8

### **Congress Secretariat**

Place: Makuhari Messe, International Conference Hall 2F, Room 202

# Presentation Guidelines

## Standby

Submit and preview your presentation data (PPT) at the PC Preview Desk at least 30 min before the beginning of your session. Please come to the next speaker's seat at the front left of the venue 15 minutes before.

## PC Preview Desk

Date and Time	Place
7/18 (Sat.) 7:45 - 18:00	Makuhari Messe, International Conference Hall 1F, Room 102
7/19 (Sun.) 7:45 - 17:00	

## Equipment to be installed at the venue

OS: Windows 11

Applications: Microsoft PowerPoint 2024

## Windows

If your presentation file is made using Windows, bring your own laptop or USB memory.

## Macintosh

If your presentation file is made using Macintosh, bring your own laptop with a HDMI and power adapter. Bringing only USB memory is NOT available.

## File Name

The title of your presentation file should be "session title\_program No.\_your name".

## File Management

Presentation files must be in Windows Power Point Office 365. The resolution is Full HD (1920 x 1080), and the screen ratio is 16:9. Use only standard OS fonts such as **Arial**, **ArialBlack**, ArialNarrow, Century, Century Gothic, **Courier**, Courier New, Georgia, Times New Roman.

## Video

If you use video, bring your own PC. We recommend MP4 format which can be played on Windows Media Player 12.

## **Operation**

In presentation, speakers should operate keypad / mouse with monitor. Don't use Presentation Tools function in PowerPoint.

## **Bringing Your Laptop**

Bring a USB memory for backup data. Bring a power adapter if you use your own laptop.

Connection is HDMI. Bring your laptop to operate seat at least 20 min before the beginning of your session. Turn off a screen saver function, energy saver, virus checker and password features in advance (as well as hot corner of Macintosh). Don't bring up your laptop on the stage.

# Instruction for Oral Sessions

## Venue

Room 8 (Makuhari Messe, International Conference Hall 3F, Room 304)

## For Chairs

1. Chairs are requested to be seated on the Next Chairs Seat at the front right of the venue, no later than 15 mins. prior to your session.
2. There is no announcement to call attention to start the session. Session composition is to be controlled by the chairs. Chairs are asked to ensure all sessions start and finish punctually as scheduled (Presentation 8 mins. Discussion 3 mins. for Oral Session, Presentation 6 mins. Discussion 2mins. for Moderated Poster Session). Additional remarks, discussions and proceedings will be left entirely up to chairs' decisions.
3. In case that the previous session finished earlier than scheduled, please wait to commence your session until the scheduled time comes.

## For Speakers

1. For speaker, the allocated time of the speech is 8 mins., followed by 3 mins. discussion.  
Only computer presentations will be available for the oral sessions. No slides or OHP shall be used. Please prepare presentation data in English. Screen ratio is 16:9 in all Session rooms.
2. The 1st slide should be the COI disclosure in your presentation.

<Examples>

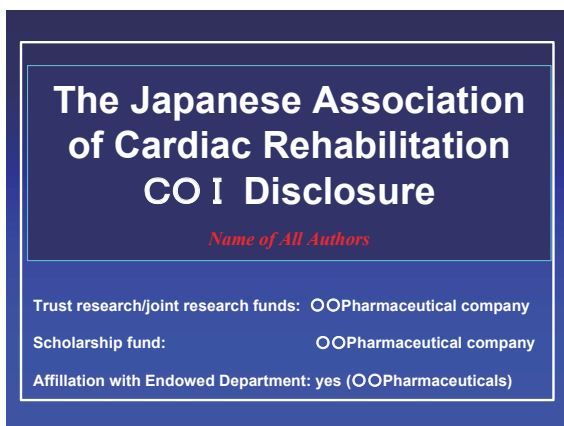

COI to disclose

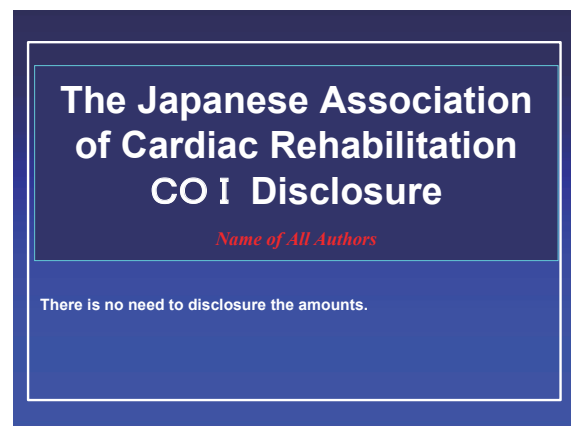

No COI to disclose

### 3. Audio-Visual Materials

- Please save your data on a USB memory, and deliver it to the PC Preview Desk. Windows is the only operating system available for the presentations. If you have prepared the presentation data on a Macintosh, you are required to bring your own PC.
- \* For those who want to show a video, please bring your own personal computer. You are also required to make sure to check that your data has not been infected by any virus in advance by using the latest version of the security software.
- Please submit your data at the PC Preview Desk, and check whether all the data are shown properly.
- Even if you use your own PC, you are required to check your presentation data at the PC Preview Desk and bring your PC to the operation desk in the session room 30 mins. prior to your session starts. Following the conclusion of your session, we will return your PC at the operation desk. Please come to the operation desk promptly to claim your PC.
- If you need any assistance with the set-up, please do not hesitate to ask for the assistance at the PC Preview Desk.
- When you are next one in line to give your presentation, please be seated on the Next Speakers Seat.

4. Speakers are requested to present their data at least 30 mins. prior to their presentation.

# Instruction for Poster Session

## Venue

AsiaPREvent and English Session Poster Area (Makuhari Messe, 1F, International Exhibition Hall 8)

## For Speakers

1. Posters will be placed for two days.
2. Please prepare presentation materials (posters) in English.
3. The poster should contain the COI disclosure statement.

<Examples>

### 【Disclosure Statement of COI】

The authors have financial conflicts of interest disclose concerning the study, explain below.

Trust research/joint research funds: ○○ pharmaceutical company

Scholarship funds: ×× pharmaceutical company

Affiliation with Endowed Department: yes (△△ pharmaceuticals)

COI to disclose

### 【Disclosure Statement of COI】

The authors have no financial conflicts of interest disclose concerning the study.

No COI to disclose

4. Presentation 6 mins. Discussion 2 mins.
5. Please check the Poster Session Area on this program to find the location of your assigned poster board.
  - Presenters are requested to mount their posters on the assigned board.
  - Poster panels are 210 cm high x 90 cm wide. Please refer to the diagram and use large-sized characters for easy reading.
  - 20 cm high x 70 cm wide of the upper part of the panel will be used for labeling your Poster Title, Affiliation, and the authors' names, which should be prepared by presenters.

Poster Posting and Removal times are scheduled as below. Please note that any posters remaining over the removal time will be disposed of by the Secretariat.

Day	Mounting	Viewing	Presentation	Removal
July. 18 (Sat.)	8:30 - 10:00	10:00 - 13:25 14:25 - 18:20	13:25 - 14:25	-
July. 19 (Sun.)	-	9:30 - 17:30	-	17:30 - 18:30

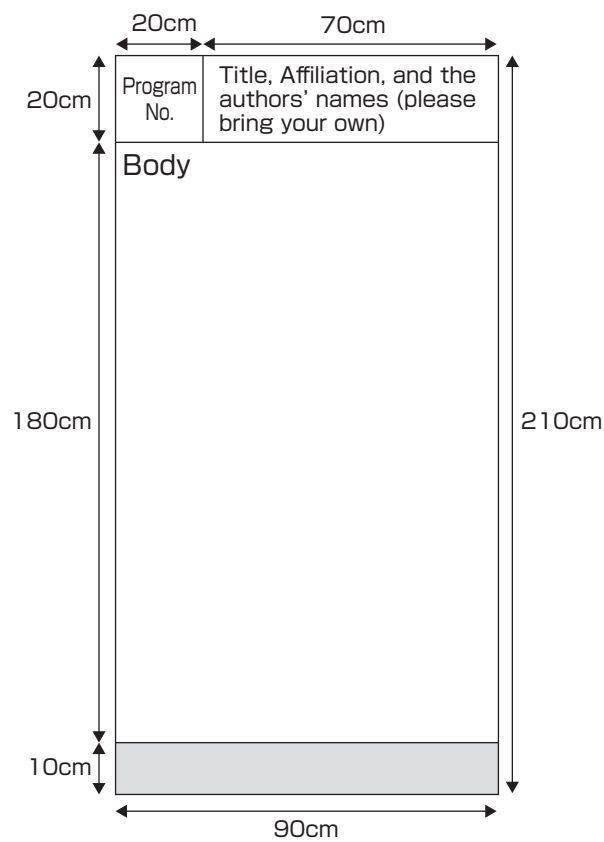

# Notice

1. Smoking is NOT permitted in the venue.
2. Turn off your mobile phone before entering the lecture rooms and Poster & Exhibition Hall.
3. In principle, taking photographs of slides and posters, recording and picture recording in the lecture rooms are prohibited without prior permission.
4. Cool Biz attire such as no tie will be permitted during the Meeting. However, please refrain from wearing T-shirts, jeans, sandals. Men should wear shirt with collar. For women office casual clothing is preferable.